

WOODBIDGE[®]

BID02 ELECTRONIC TOILET SEAT



Customer Service Phone: 562-229-0088. (Monday - Friday 9 AM - 5 PM Pacific Time)

Or Email: help@woodbridgebath.com

www.woodbridgebath.com

01

Smart Seat BID02 – Overall Introduction



- Super slim and elegant modern
 - design Overall height only 4 1/2"
 - Universal shape that can fit most elongated toilets in the market
-
- Remote control and manual button available
 - Manual button finish: Painting / Chrome plated
-
- Overall dimension: 20 3/8" * 15 7/8" * 4 3/8"

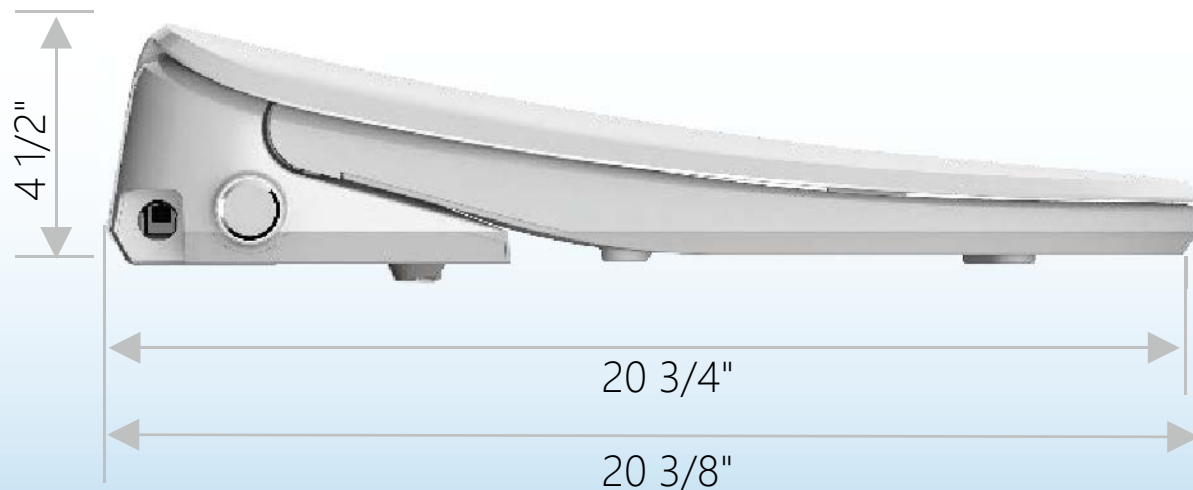

Smart Seat BID02 – Main Functions

	Instant heating	●
Wash	Rear wash	●
	Front wash	●
	Massage wash	●
	Water temperature adjustment	●
	Spray location adjustment	●
	Water pressure adjustment	●
Clean	Spray nozzle self-cleaning	●
	Spray nozzle detachable	●
	Anti-bacterial nozzle	●
	Quick disassembly	●
	Water filtration	●
	Deodorization	Optional
	Anti-bacterial seat	●
	Pulse wash	Optional
	UV/Plasma sterilization	Optional
Comfort	6 Safety devices	Water temperature sensor, Thermostat, temperature fuse, Over temperature water cut-off protection, Ground protection, Leakage protection device
	Seat cover Material	PP material
	Heated seat	●
	Seat temperature adjustment	●
	Soft closing	●
	Night light	Smart light sensor, Normally on/off
	Automatic seat on/off	Induction sensor
	Drying device	●
	Wind temperature adjustment	●
	Continuous warm wash	●
	Mix steam wash	Naturally aspirated spray
	Control	Manual buttons + Remote control
Additional functions	Digital display	/
	ECO mode	●
	Nozzle(Plastic/Metal)	Optional



Smart Seat BID02 – Main Specifications

Model	BID02		
Rated Voltage	AC 110V		
Rated Frequency	60Hz		
Rated Power	1040W		
Maximum Power	1200W		
Heating Method	Instant heating		
Water pressure range	0.07MPa-0.8MPa (Static)		
Inlet water temperature	3-35°C		
Environment Temperature	0-40°C		
Wind Volume	> 0.2m³/min		
Water volume (Rear wash)	0.45L--0.63L/min		
Water volume (Front wash)	0.45L--0.63L/min		
Water volume (Nozzle self-cleaning)	0.48L--0.58L/min		
Spray type (Buttock wash)	Naturally aspirated gentle wash		
Spray type (Women wash)	Naturally aspirated gentle wash		
Water temperature	Water temperature (6 levels) (neutral included) (Normal temperature-about 40°C)		
Seat surface temperature	Seat temperature (6 levels) (neutral included) (Normal temperature-about 40°C)		
Drying temperature	Wind temperature (6 levels) (neutral included) (Normal temperature-about 40°C)		
Safety Device	Water temperature sensor, thermostat, temperature fuse, ground protection, leakage protection device, anti frost cracking device, water pressure protection device.		
Standard	GB 4706.1-2005\GB 4706.53-2008		
Electrical Wire	About 1.6m		



BID02 Product Advantages

1. Compatibility



1.1 Product dimension

- Layered seat and lid design.
 - User-centered engineering design.
 - Universal design that can fit most elongated toilets in the market.
- Mounting surface depth only 20 3/4"**

BID02 Product Advantages

1. Compatibility

1.2 V-shape front contour

- Widened arc-shaped outline in front end and more comfortable for sitting.
- Compatible with most elongated toilets in the market.
- Covers toilet ceramic fully to avoid clothes and body touching the toilet. More hygienic.



BID02 Product Advantages

2 Appearance advantage – Slim and light



2019 New technology, shorter seat cover overall height.

The overall height is only 4 1/2", while the height of most smart toilet seats in the market is around 5 1/8"-5 1/2", which is much thicker than BID02.

BID02 Product Advantages

2 Appearance advantage – Simple and good-looking



Simple and modern design, suitable for a variety of bathroom decoration styles. Easy to clean.

BID02 Product Advantages

3. Easy to use

One-button manual control

User-centered button design. Easy to use for all ages.

9 different functions in one button



BID02 Product Advantages



4. Ergonomic seat design

- Wide seating surface
- Arc-shape seating surface, comfortable for sitting
- Big urinal space for man

4. Seat Design

4.1 Suitable for people with different weight

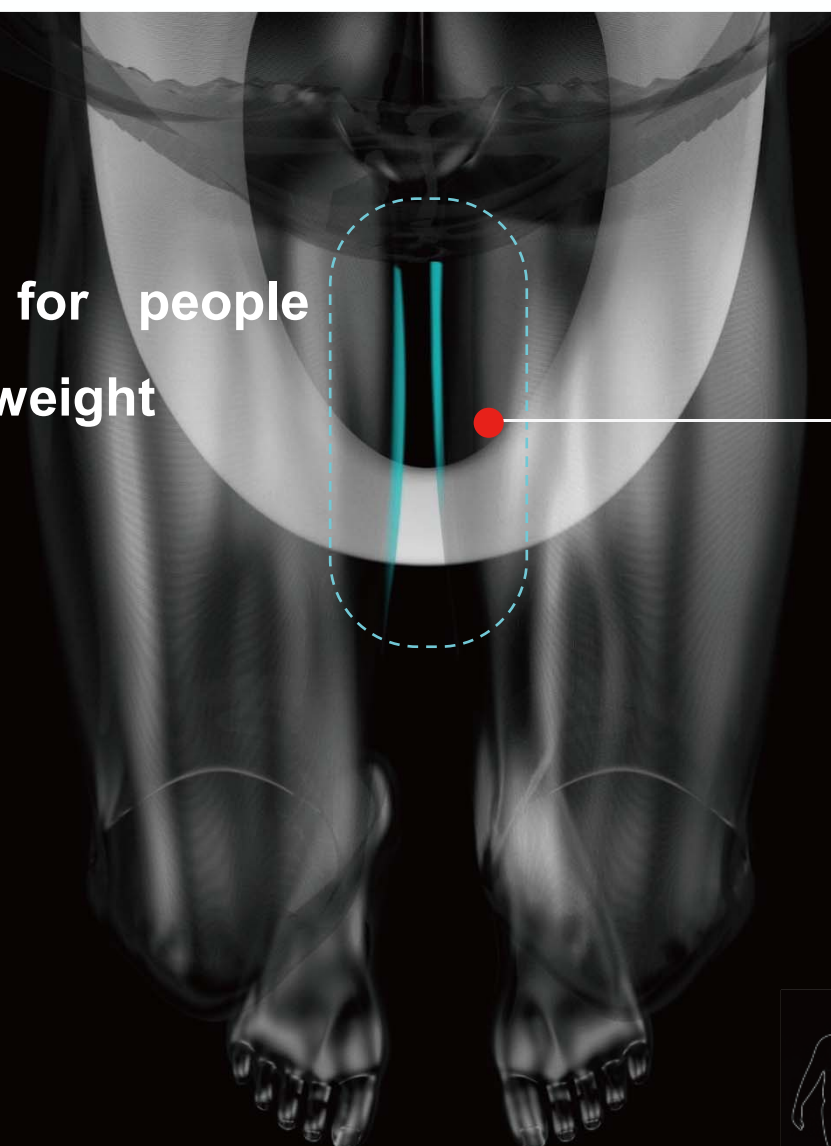

Big urinal space for men

- The BID02 seat is suitable for users with different weight. It's proved that V3200 can be used for users weighing up to 90KG through user experience survey.
- Most current smart seats in the market doesn't have enough urinal space for men or are unsuitable for big users.

User Experience Survey



User A
Weight : 85KG
Height: 170CM

User B
Weight 80KG
Height : 170CM

4. Seat Design

4.2 Comfortable seat

- Full layered design in cover and seat. The seating space is wider in front and the seat supporting surface is larger.

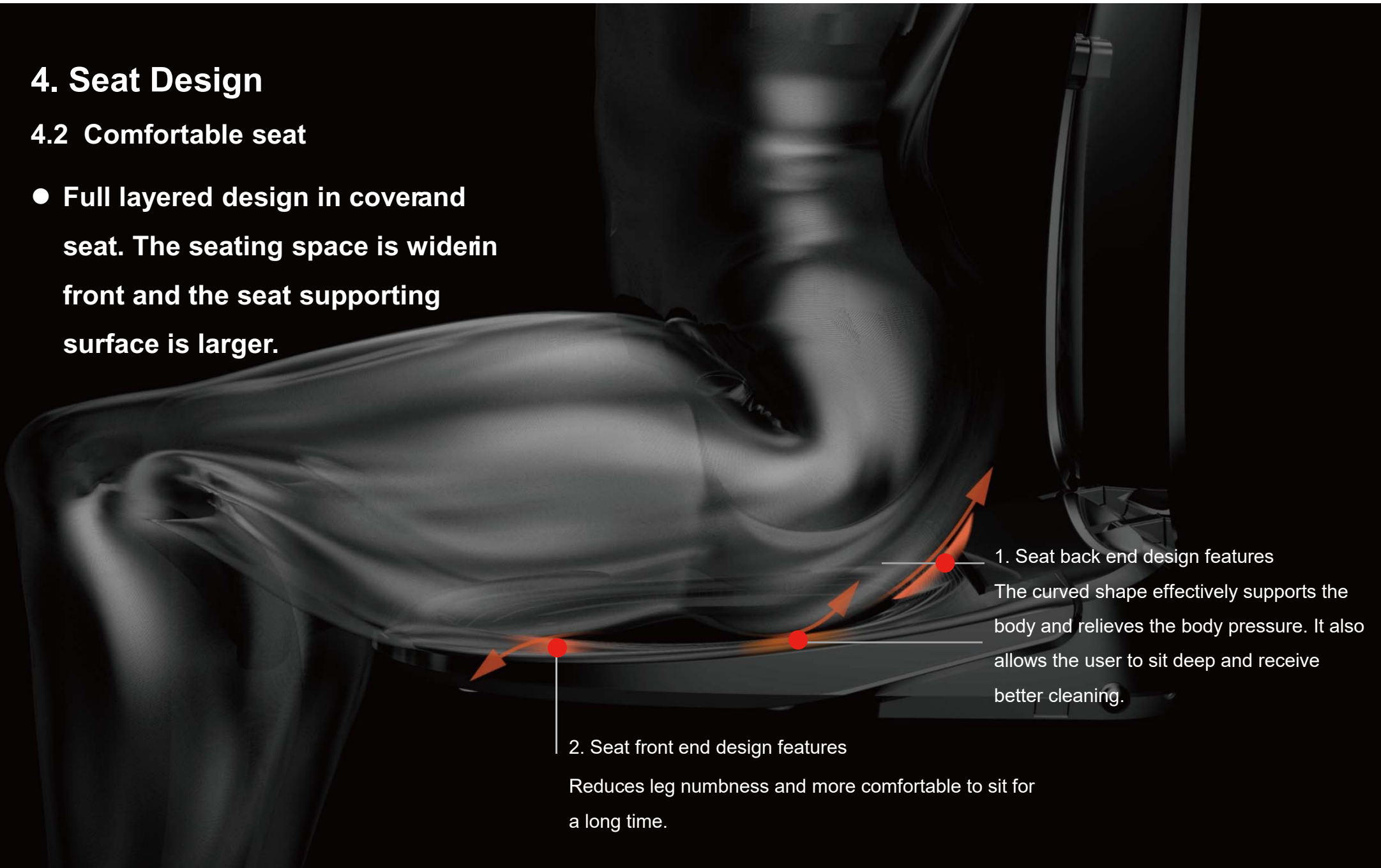

4. Seat Design

4.3 Full layered design – More convenient and hygienic to use



There's a angle between lid and seat, making it easy to lift and put down.

For most smart toilets in the market, the seat doesn't cover the toilet ceramics fully. It's easy for users to get clothes and body dirty.

The seat of BID02 protrudes from the edge of the ceramic toilet to avoid user's leg or clothes touching ceramic surface.

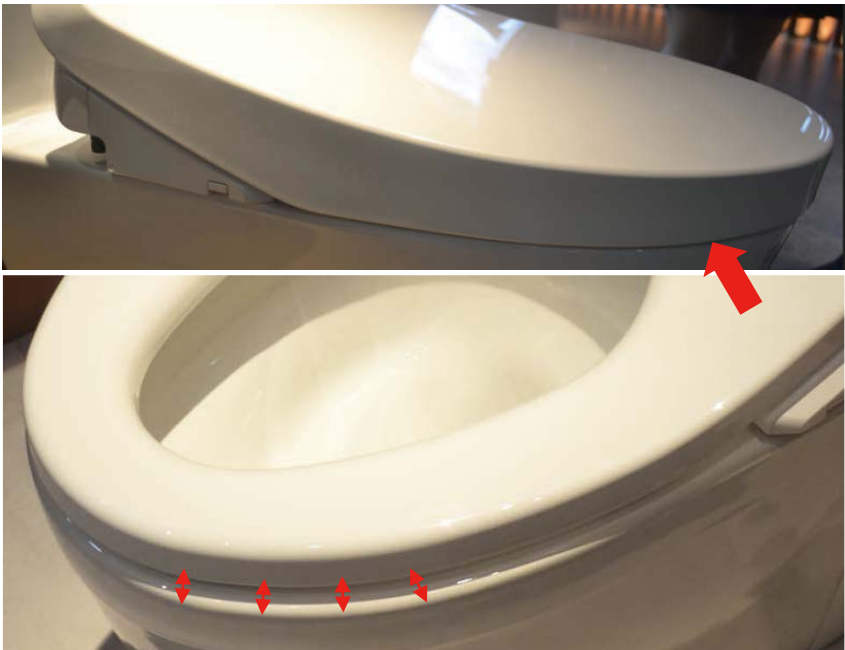
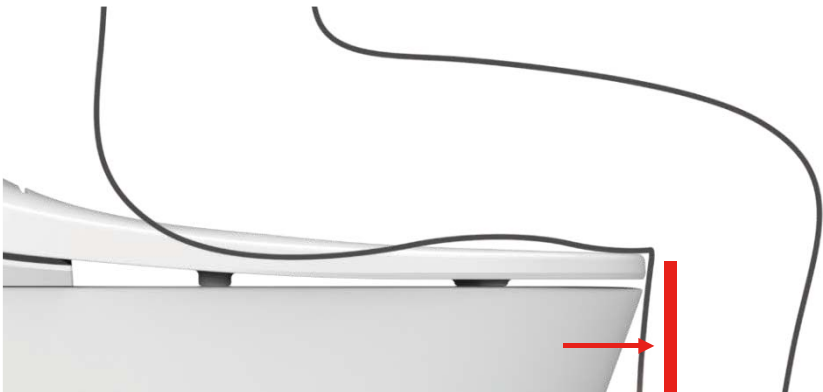

5. Curved stainless steel spray rod

Better spray rod

- Compared with straight spray rod, BID02 curved spray rod is away from the waste during the cleaning process.
- The spray rod is not easily stained and more sanitary.

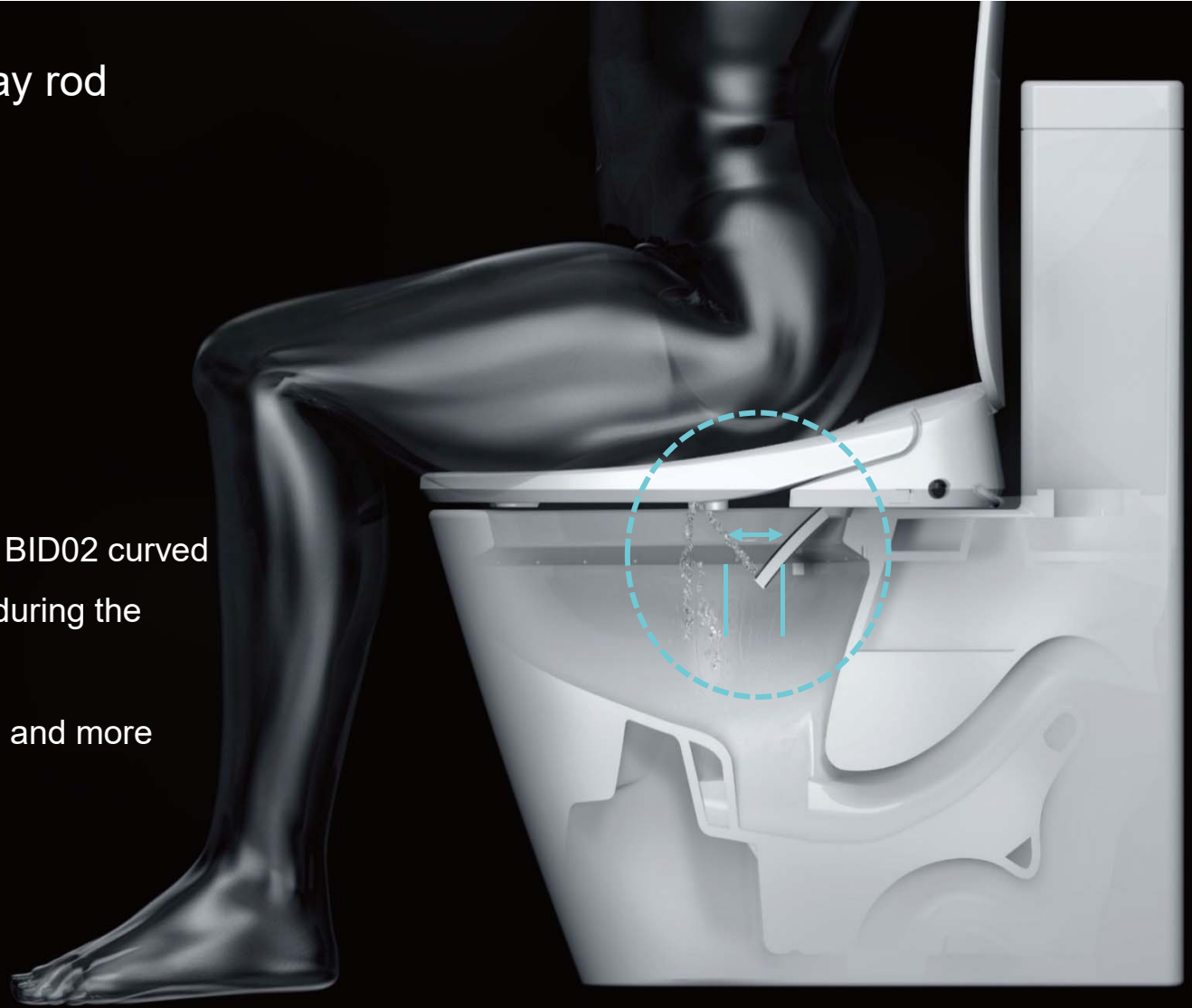

5. Curved stainless steel spray rod

Curved spray rod optimizes the cleaning range, so that the spray rod does not need to extend too long to achieve the same cleaning effect and also the spray rod is further away from waste during use. It is healthier and more hygienic.

Comparison of spray rod extended distance in level 5 cleaning

The spray rod of BID02 is further away from dirt falling place.

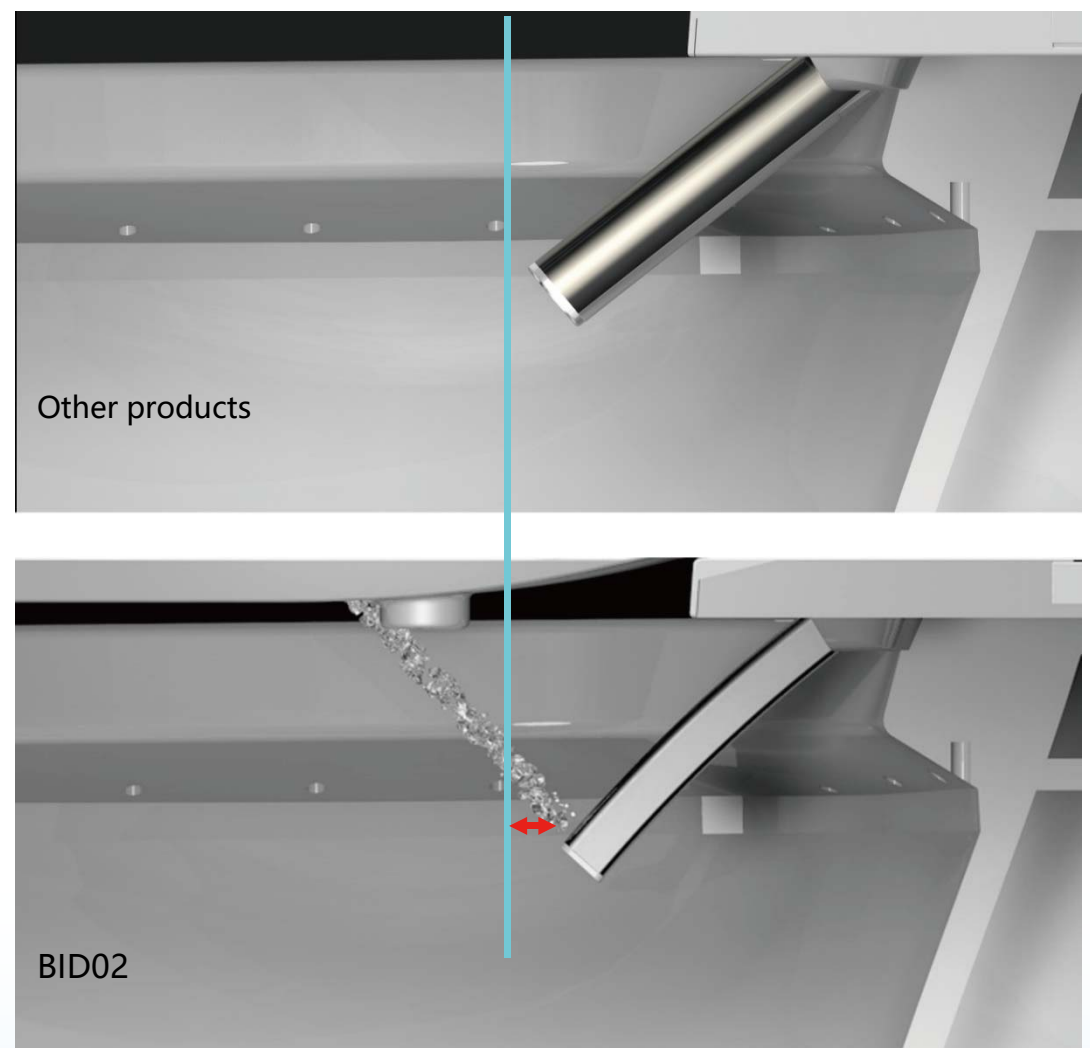

5. Curved stainless steel spray rod

Detachable nozzle

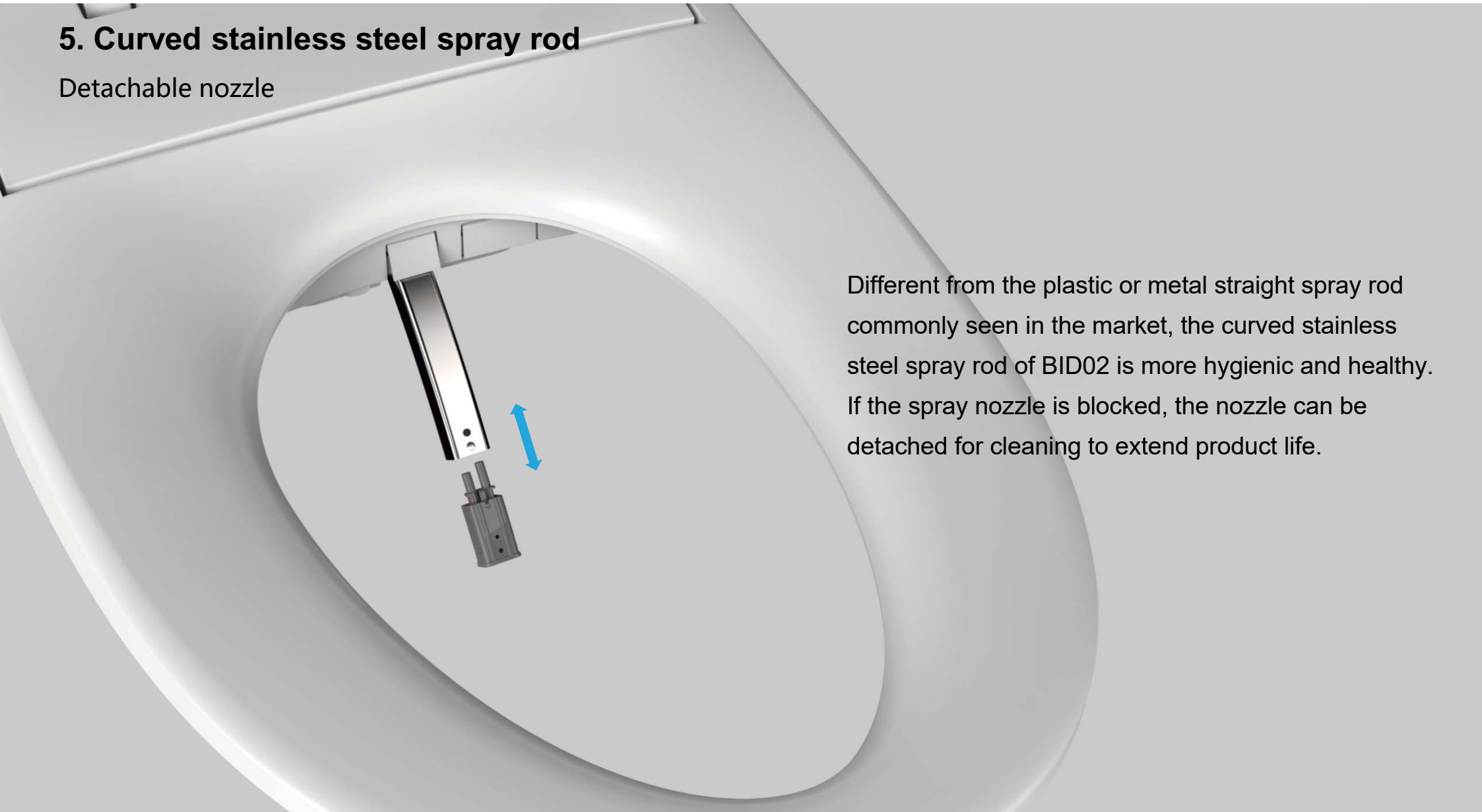

Different from the plastic or metal straight spray rod commonly seen in the market, the curved stainless steel spray rod of BID02 is more hygienic and healthy. If the spray nozzle is blocked, the nozzle can be detached for cleaning to extend product life.

6. Lightless catalyst deodorization

The lightless catalyst can generate a catalytic reaction under lightless conditions, which can largely and continuously eliminate harmful air pollutants and convert pollutants into harmless water and carbon dioxide to achieve deodorization and air purification from the source. It makes the air fresher and compared with activated carbon, the lightless catalyst can be used for a longer time.





7. Pulse massage wash by air pump

BID02 has pulse massage wash function, which is comfortable and enriches user's cleaning experience.



8. Warm and cold water cycling wash

- **BID02 has warm and cold water cycling wash function. The stimulation of warm and cold water by turns expands and shrinks blood vessels in buttock, which will increase blood vessel elasticity and its tolerance to outside stimulation, providing you with a healthier way of buttock washing.**

9. Leakage protection wire

Electrical wire 1.6m long, equipped with 10mA leakage protection device to ensure safety.



Safe and Reliable

10. Vibration friction welding

The lid and seat of BID02 is welded into one body through vibration friction welding. The seat cover has excellent strength and waterproof performance.

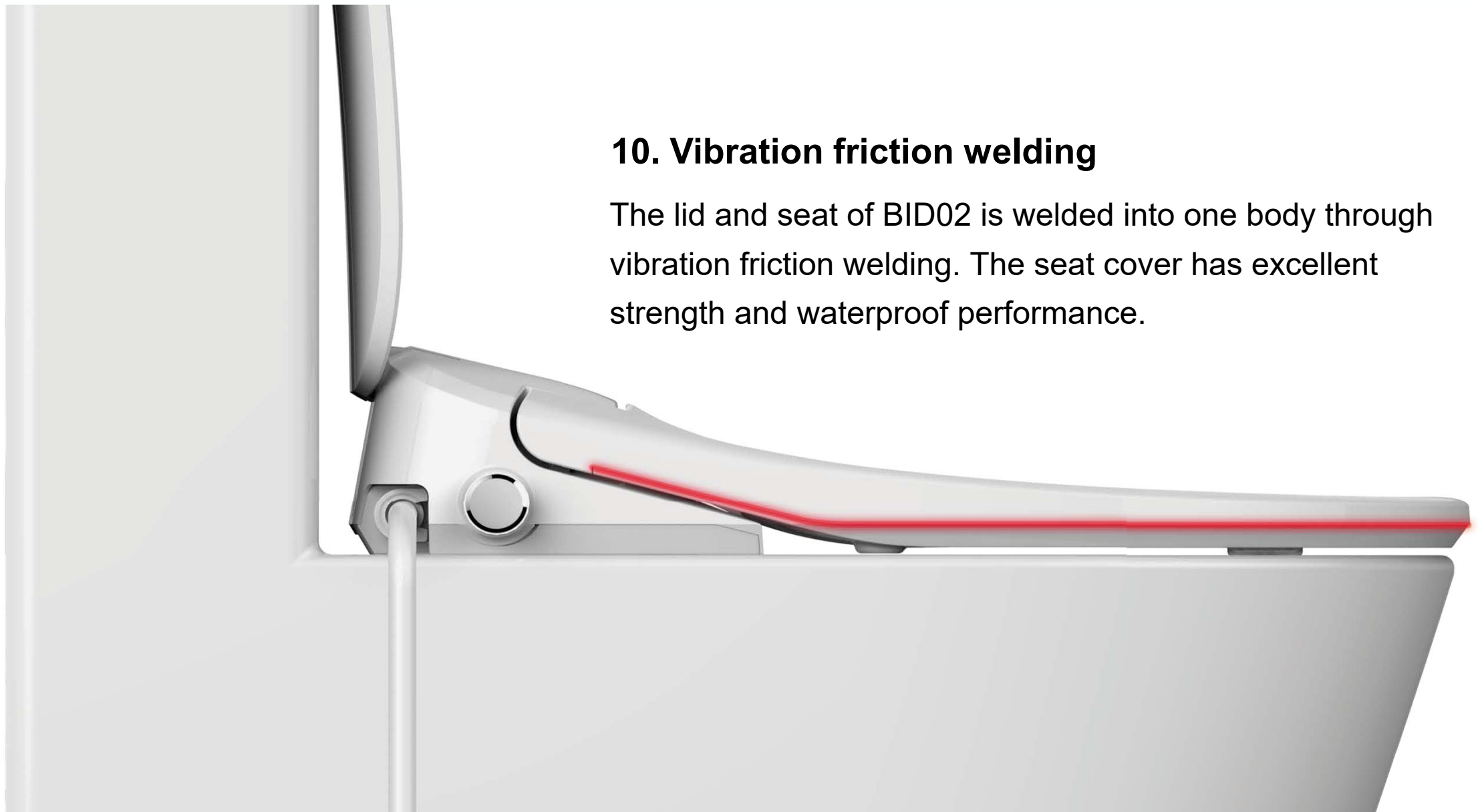



11. Pressure Stabilizing & Pressure release module

The core patented component - pressure stabilizing valve, is equipped with a pressure relief module, which can prevent the waterway from bursting even in the case of pressure stabilizing valve failure. This can prevent consumer property damage caused by leakage and can also protect consumer and property safety in extreme conditions.

12. Top-class heating pipe

- Equipped with world top-class instant heating ceramic heating pipe imported from Japan, BID02 can heat water as cold as 5 °C to 30 °C in 1 second.
- Bring the warmest care to users in the coldest winter.

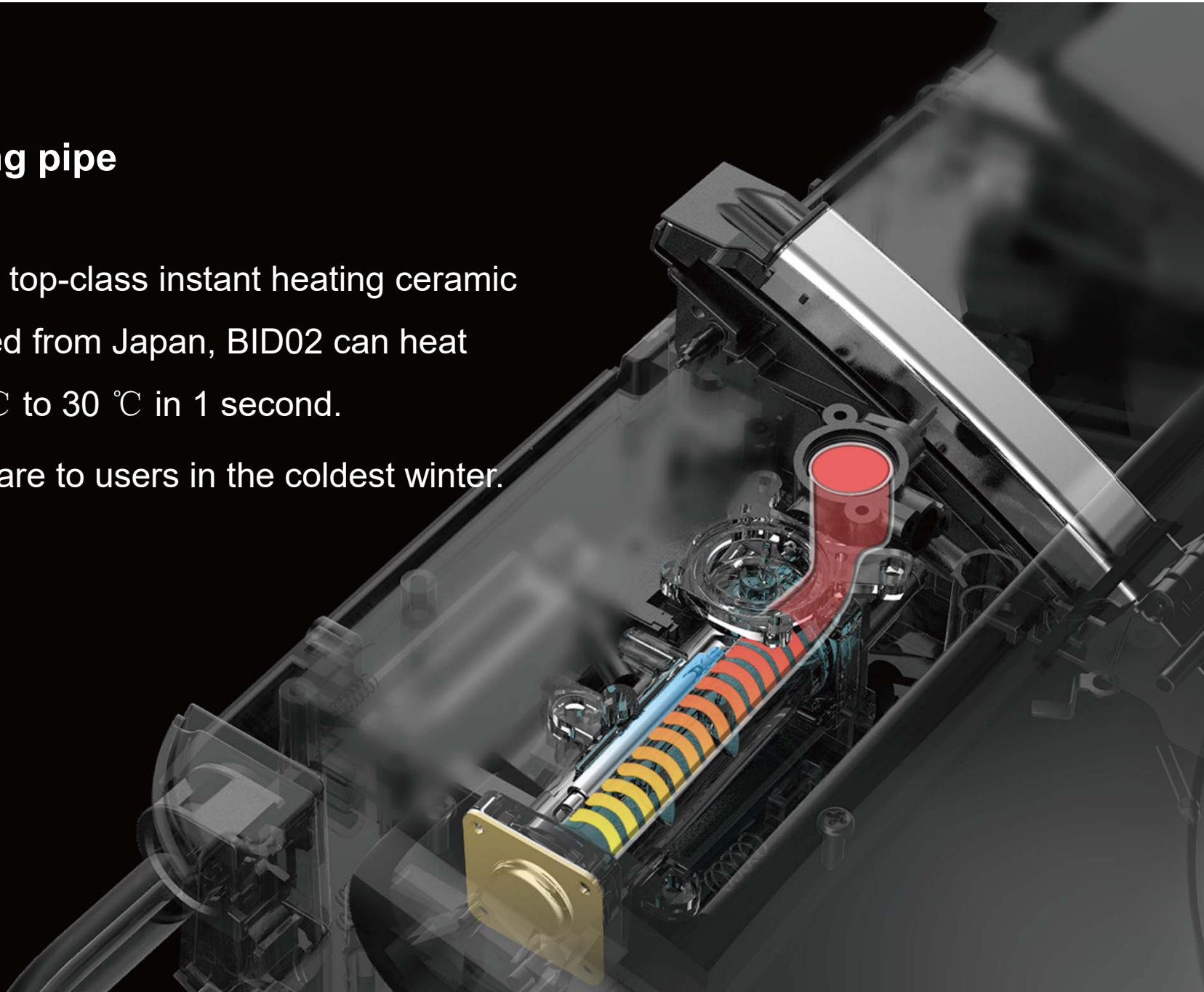



13. Capacitive seating sensor

- Capacitive seating sensor is embedded in the seat to identify if a person is sitting on the seat. With no person in seat, the nozzle won't spray water by mistake.

14. Aluminum foil heating film

- The seat is fully equipped with aluminum foil heating film, which distributes heat evenly, stabilizes heat and saves electricity.
- The combination of NTC and temperature fuses gives consumers intimate care and assured protection.

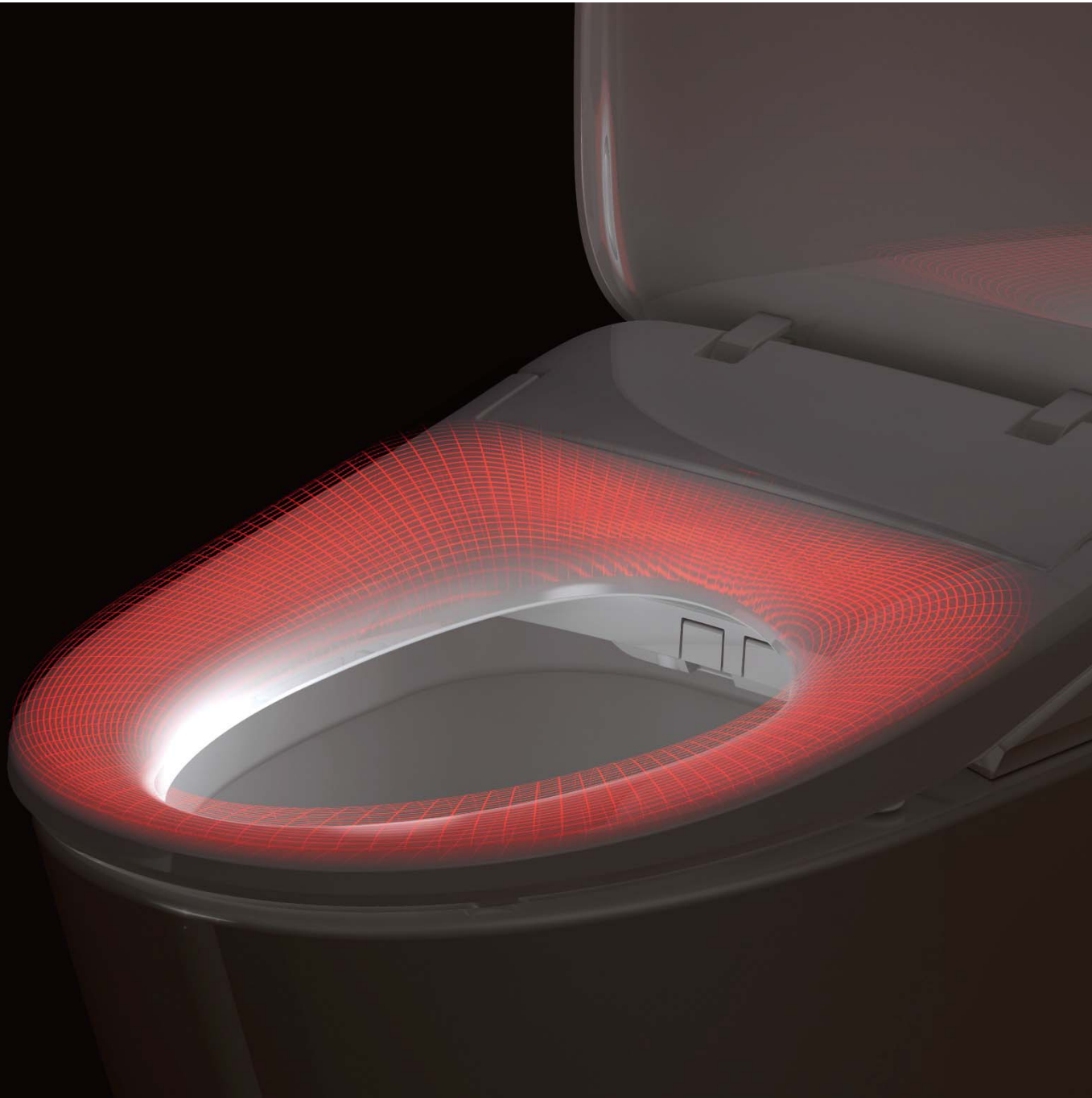

15. Soft closing cover

- Unique patented soft closing seat cover
- Superior soft closing function. WOODBRIDGE ultrasonic welding sealing damper **KO** other screw-locked sealing dampers in the market in aspects of preventing oil leakage and function failure.

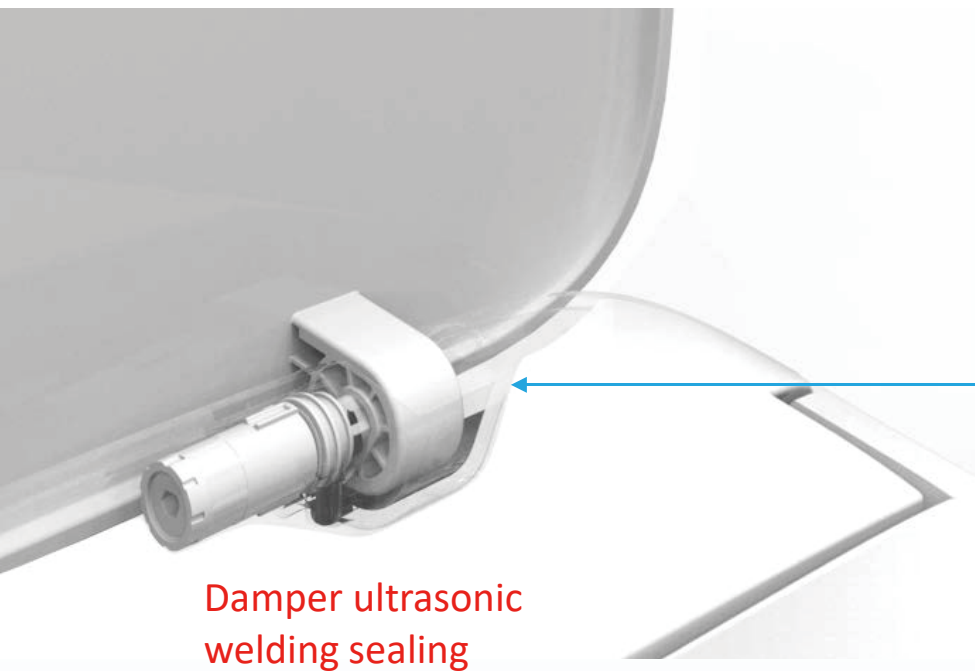

16. Direct plug-in connector

- Different from the threaded inlet connector of other products on the market, WOODBRIDGE BID02 uses direct plug-in connector and clamp to fix water inlet tube, which makes the disassembly and assembly faster and easier.



17. Soothing night light design

Use **warm white** for night light, which makes the lighting more pure and peaceful at night.

Under ECO mode, the manual button is in **breathing light** mode, showing its location.



18. Anti-freeze

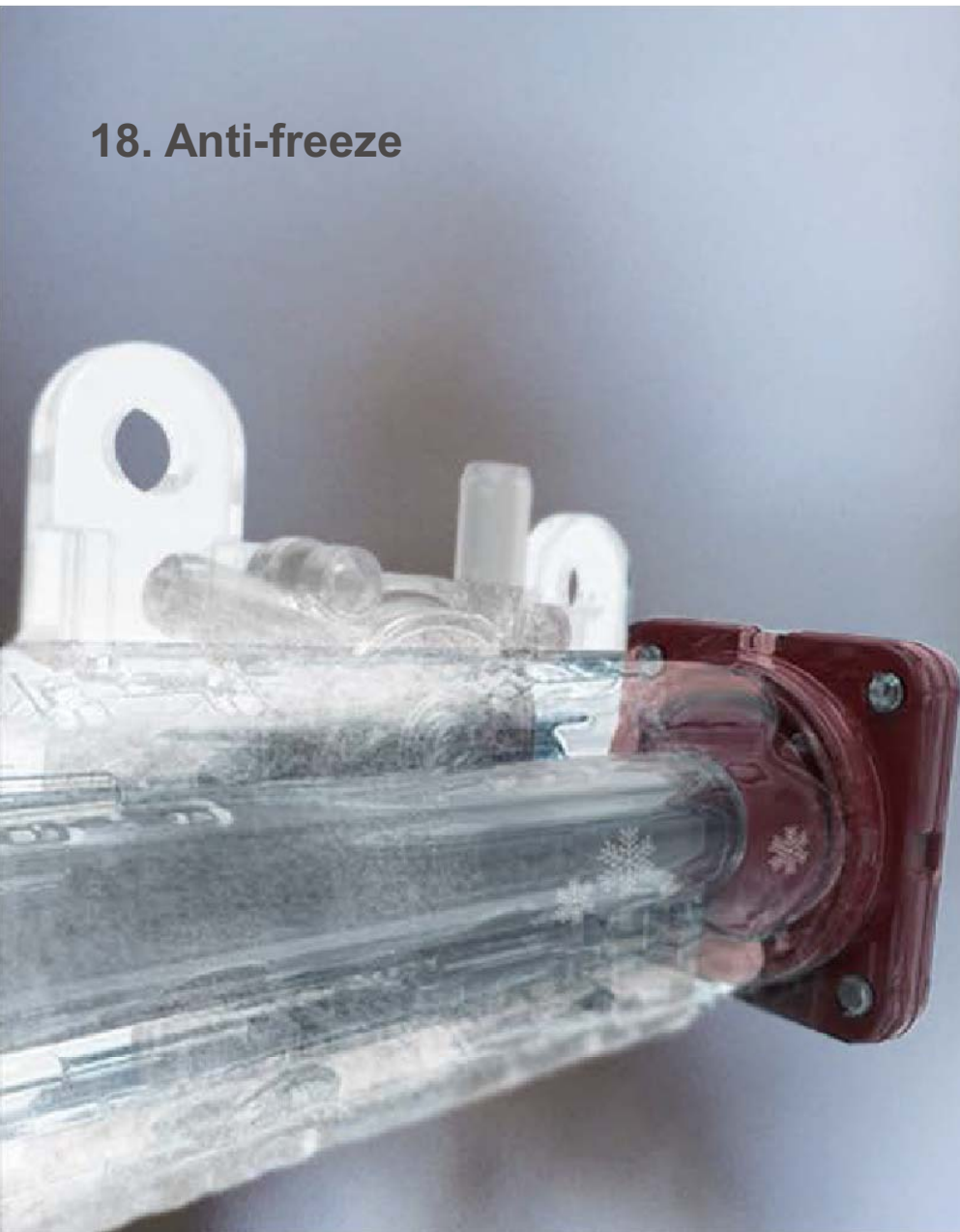

Operating principle:

When water freezes at 0°C , it'll expand and increase its volume, which will put pressure on the plastic wall and crack it.

WOODBIDGE anti-freeze function prevents cracks through smart design in instant heating assembly. This feature is rarely found in other smart seats in the market.

Target environment:

Logistics transportation

Seat left unused for a long time under low room temperature

19. Remote Control

- IPX7 Waterproof
- Practical one-hand remote control
- Comfortable touch in hand



WOODBIDGE[®]

BID 02 ELECTRONIC TOILET SEAT

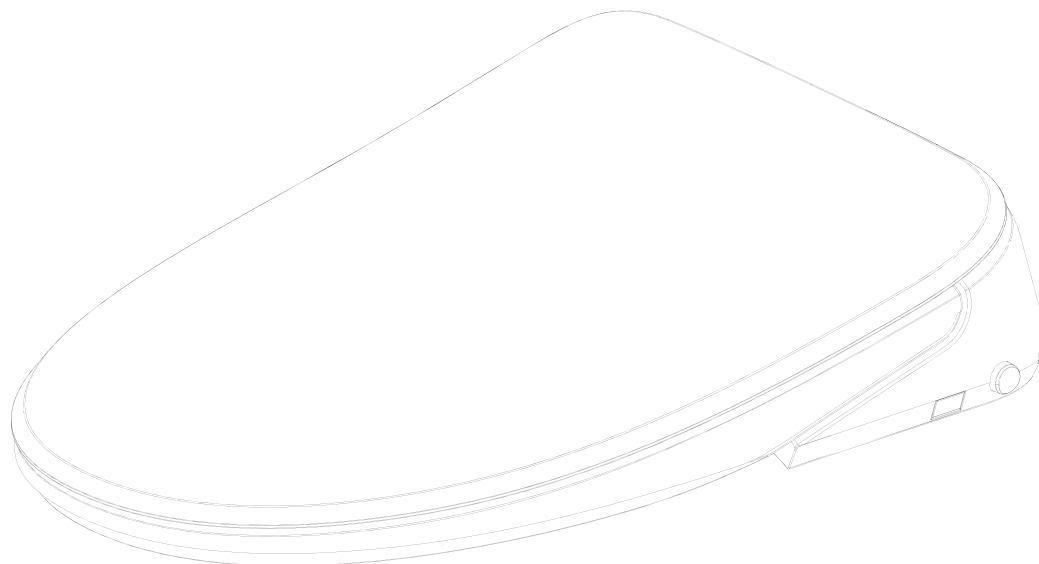

Customer Service Phone: 562-229-0088. (Monday - Friday 9 AM - 5 PM Pacific Time)

Or Email: help@woodbridgebath.com

INSTALLATION MANUAL BID 02

WOODBIDGE[®] **ELECTRONIC TOILET SEAT**

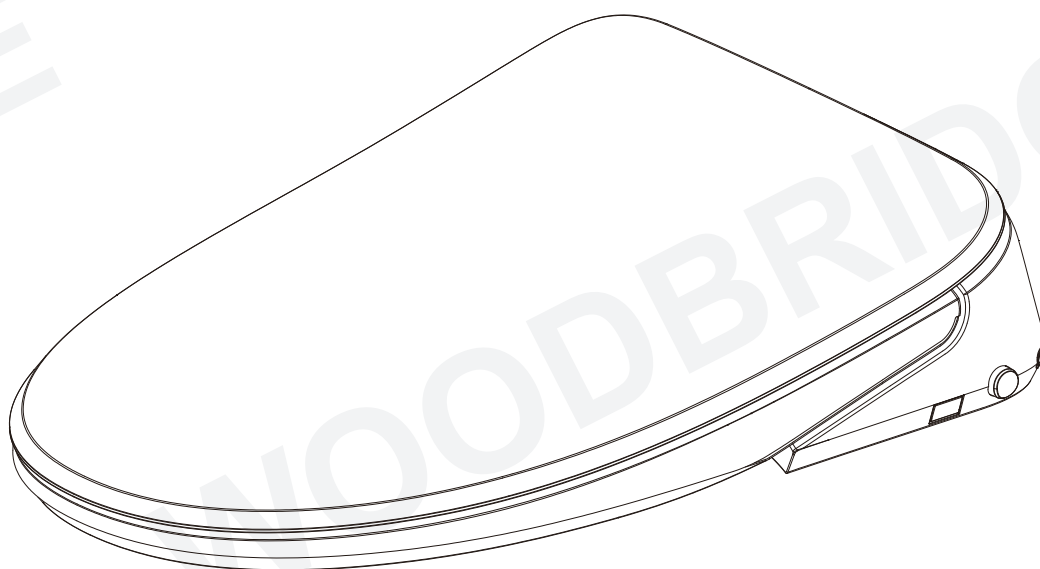

Installation Manual

- Thank you for choosing our products. Please read the instructions carefully before installation and keep it available for future maintenance or reference.
- Our company reserves the right of final interpretation for this manual. The manual is subject to change without notice.

Customer Service Phone: 562-229-0088. (Monday - Friday 9 AM - 5 PM Pacific Time)
Or Email: help@woodbridgebath.com

2020413 REV. 3

When using electrical products, especially when children are present, basic safety precautions should always be followed, including the following:

1. The appliance is not to be used by persons (including children) with reduced physical, sensory or mental capabilities, or lack of experience and knowledge, unless they have been given supervision or instruction.
2. Children being supervised not to play with the appliance.
3. This appliance can be used by children aged from 8 years and above and persons with reduced physical, sensory or mental capabilities or lack of experience and knowledge if they have been given supervision or instruction concerning use of the appliance in a safe way and understand the hazards involved.
4. Children shall not play with the appliance.
5. Cleaning and user maintenance shall not be made by children without supervision.

READ ALL INSTRUCTIONS BEFORE USING



DANGER—To reduce the risk of electrocution:

1. Do not use while bathing.
2. Do not place or store product where it can fall or be pulled into a tub or sink.
3. Do not place in or drop into water or other liquid.
4. Do not reach for a product that has fallen into water. Unplug immediately.
5. Do not wash the main unit or electrical plug with water or detergent.
6. Do not handle the electrical plug with wet hands.
7. Do not put a hand or other staff over the outlet of air dryer or block the outlet of air dryer.
8. Never disassemble, repair or modify this product.
9. During installation, disassembly, repair and maintenance of the product, the power plug must be switched off and water supply be shut off.



WARNING—To reduce the risk of burns, electrocution, fire, or injury to persons.

1. Close supervision is necessary when this product is used by, on, or near children or invalids.
2. Use this product only for its intended use as described in this manual. Do not use attachments not recommended by the manufacturer.
3. Never operate this product if it has a damaged cord or plug, if it is not working properly, if it has been dropped or damaged, or dropped into water. Return the product to a service center for examination and repair.
4. Keep the cord away from heated surfaces.
5. Never use while sleeping or drowsy.
6. Never drop or insert any object into any opening or hose.
7. Do not use outdoors or operate where aerosol (spray) products are being used or where oxygen is being administered.
8. Connect this product to a properly grounded outlet only. See Grounding Instructions.
9. Do not throw cigarettes and other burning stuff into toilet, otherwise it might cause fire.
10. This product is electric appliance, so it must be placed far away from water. Please don't drench urine and other liquid to it.
11. Do not lay on side or upside the product during the electrical circuit.
12. It is prohibited to use other electric appliances in the same socket.
13. It is forbidden to use the power extension or unstable loose outlet.
14. The old aging water supply hose can not be used, otherwise it might cause leakage, fire or electrical shock. Installation of the bidet seat should include specified components and new water supply hose.



CAUTION—Indicates that failure to follow the instruction may cause body injury or property damage.

1. Do not install or use the product in wet places as steam room etc. This product must be connected to properly grounded power outlet socket.
2. It is recommended to use water-proof electrical outlet which should be installed in the place where is not easily got wet.
3. This product should be used with AC 110V-120V, 50/60Hz electrical current only, load current is at least 15A. Power plug must be equipped with ground fault circuit interrupter or ground fault electrical leakage protector or similar high sensitive, rapid type leakage switch (Rated sensitive current under 6mA).
4. When it thunders, it is strongly recommended to pull out the power plug.
5. Do not stand on ceramic toilet.
6. Ceramic toilet must install floor fixing bolt.
7. Do not stand on product unit, seat and cover.
8. Do not lean against the seat cover when using the product, to avoid damage.
9. This product is equipped with soft-closing seal cover. Heavy pressing or pushing may damage the soft-closing damper.
10. Do not use lacquer thinner, petrol, liquid medicine, detergent, insecticide, toilet cleanser and scrubbing brush to clean the product.
11. Exposure to direct sunlight is prohibited.
12. Only use tap water or potable water; otherwise it may cause chafing.
13. Do not connect water supply to heater outlet. Make sure inlet water temperature at 3~35°C
14. When the room temperature is under zero degree, please dry up the water tank, to avoid freezing.
15. Raise rest room temperature to prevent the toilet from damage due to freezing.
16. When move the product from cold or wet environment into normal room temperature, wait for 2 hours until the condensation water is fully volatilized. Doing so can prevent the product from electrical short-circuit.
17. When not using the product over three(3) days, drain the water out of the container and pull the electrical plug from the wall outlet.
18. Stop using the product and shut off the power when product malfunctions, please contact the service people for professional service.

GROUNDING INSTRUCTIONS

This product should be grounded. In the event of an electrical short circuit, grounding reduces the risk of electric shock by providing an escape wire for the electric current. This product is equipped with a cord having a grounding wire with a grounding plug. The plug must be plugged into an outlet that is properly installed and grounded.



DANGER — Improper use of the grounding plug can result in a risk of electric shock.

If repair or replacement of the cord or plug is necessary, do not connect the grounding wire to either flat blade terminal. The wire with insulation having an outer surface that is green with or without yellow stripes is the grounding wire.

This product is factory equipped with a specific electric cord and plug to permit connection to a proper electric circuit. Make sure that the product is connected to an outlet having the same configuration as the plug. No adapter should be used with this product. Do not modify the plug provided — if it will not fit the outlet, have the proper outlet installed by a qualified electrician. If the product must be reconnected for use on a different type of electric circuit, the reconnection should be made by qualified service personnel.

SAVE THESE INSTRUCTIONS

Technical Specification

Main Unit	Rated voltage	110-120V, 50/60Hz
	Rated power	960W
	Water pressure range	The minimum necessary pressure 0.08MPa (hydrostatic pressure), the maximum water pressure 0.8MPa (hydrostatic pressure)
	Power Cord	length is about 1.2m
Cleaning device	Heating power	1400W(120V)
	Water temperature	6-level water temperature adjustment
	Water volume	5-level adjustment
	Cleaning mode	Rear cleaning / Massage cleaning, Front cleaning /Massage cleaning
	Nozzle position	5-level adjustment
	Water pressure protector	Pressure stabilizer, Automatic pressure discharging device
	Anti-fouling device	Anti-syphon device, Anti-backflow device, Filter device
	Safety device	The water temperature sensor, Anti-burning apparatus, Thermostat, Temperature fuse, Ground fault protection, Leakage protection , Anti-freeze cracking device
Drying device (If Applicable)	Warm wind speed	Over 0.2m³/min
	Warm wind temperature	6-level adjustment
	Heating power	200W
	Safety device	High temperature preventer, thermal fuse
Deodorization	Deodorization Method	None Photocatalyst
Heated seat	Surface temperature	6- level adjustment
	Heating power	50W
	Open and close device	Soft close
	Prevent low temperature burn	After 10 minutes of use, the seat temperature will automatically drop slowly to a low level
	Safety device	Seat sensor, Temperature sensor, Bimetal thermostat, Thermal fuse
Caring device	Night light assembly	Smart, Always on, Always off
	Noise-free setting	The buzzer is off at night to avoid buzzer noise to guarantee a quiet environment at night
	User ID setting	To avoid disturbance from remote controls by multi-user
Sterilization device (If Applicable)		Plasma sterilization device
Antibacterial position		Seat, Nozzle

Components Name

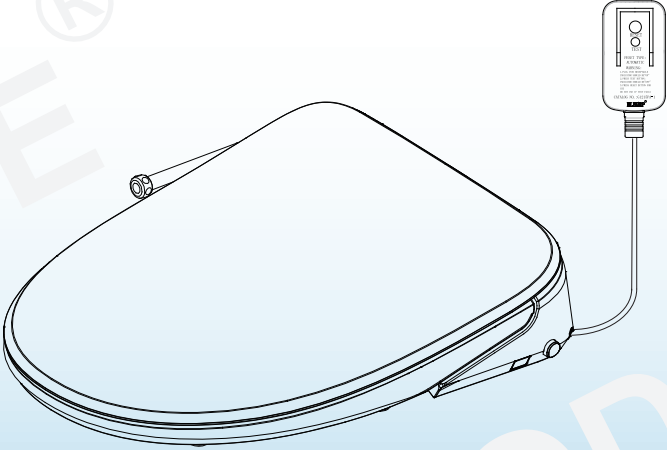
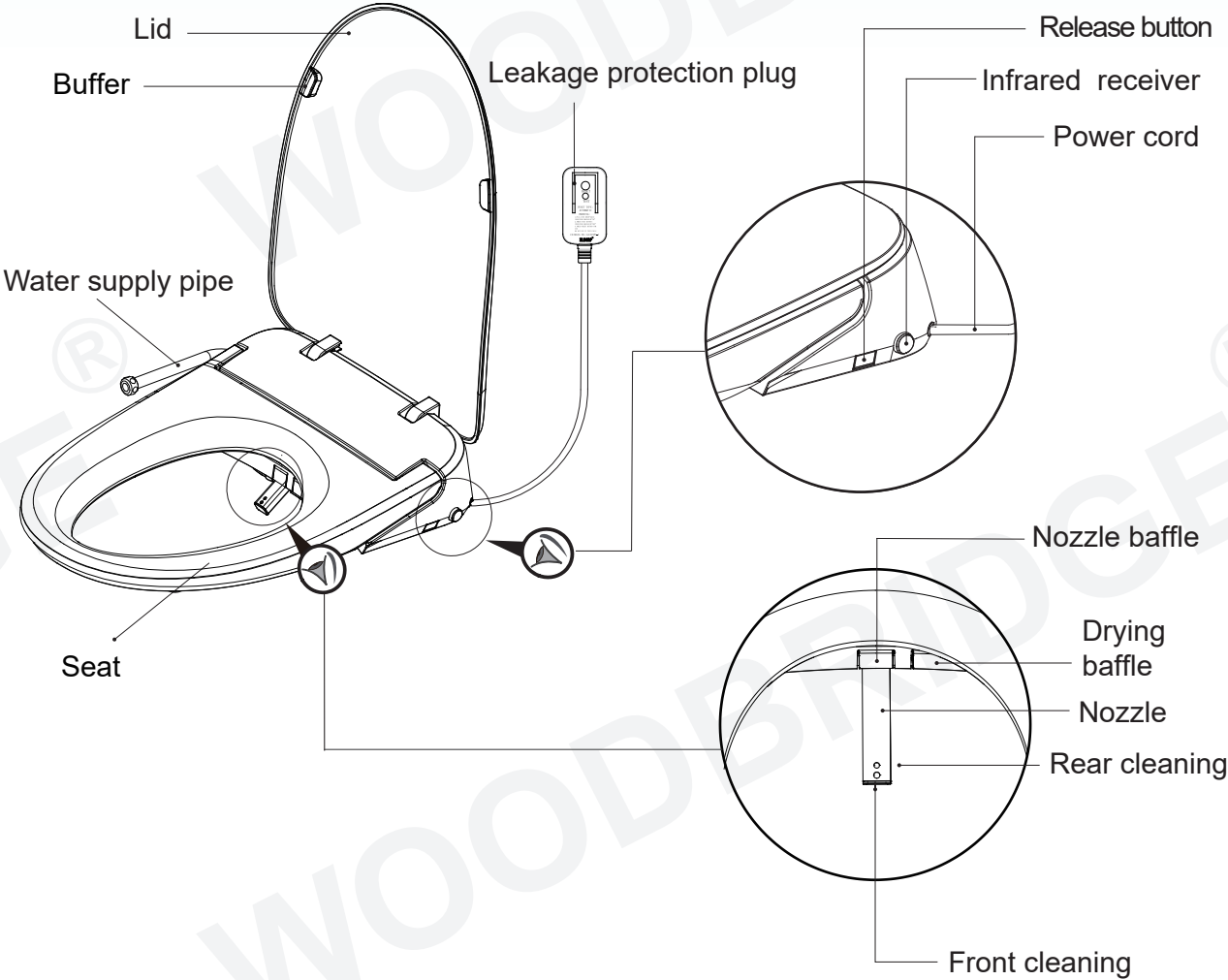





Whole set of product



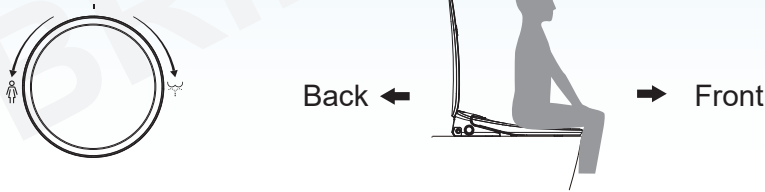

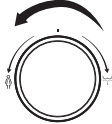

The remote control



Main Unit Knob Instructions (Knob Applies)

		
Rear Cleaning Knob	<ol style="list-style-type: none"> 1. When people is seated, turn Rear Cleaning Knob forward to start rear cleaning function; Rear cleaning → Drying→Stop drying automatically. 2. During rear cleaning, turn the knob forward, the washing position moves forward, otherwise, the washing position moves backward. 	
Front Cleaning Knob	<ol style="list-style-type: none"> 1. When people is seated, turn Front Cleaning Knob backwards to start front cleaning function; Front cleaning→ Drying →Stop drying automatically 2. During front cleaning, turn the knob backwards, the washing position moves backward, otherwise, the washing position moves forward. 	
Stop Knob	Press the knob vertically to stop the function in progress: rear cleaning, front cleaning, drying or nozzle cleaning function.	

Main Unit Side Button Instructions (Button Applies)

	
 Rear Cleaning Button	<ol style="list-style-type: none"> 1. When people is seated, press Rear Cleaning Button shortly to start rear cleaning function; Rear cleaning → Drying→Stop drying automatically 2. When rear cleaning function is on, long press Rear Cleaning Button to massage cleaning function; long press again to stop massage cleaning function. 3. When the cleaning function is on, shortly press Rear Cleaning Button, the nozzle will move back by one step; 4. When no one is seated, press Rear Cleaning Button, the nozzle will stretch out, people can wash the nozzle manually.
 Front Cleaning Button	<ol style="list-style-type: none"> 1. When people is seated, shortly press Front Cleaning Button to start front cleaning function; Front cleaning → Drying → Stop drying automatically 2. When front cleaning function is on, long press Front Cleaning Button to start massage cleaning function. Long press Front Cleaning Button again to turn off massage cleaning function. 3. When cleaning function is on, shortly press Front Cleaning Button, the nozzle will move forward by one step.
 Stop Button	<ol style="list-style-type: none"> 1. Long press Stop Button to make the main unit enter standby mode, press Stop Button again to make the main unit return to Operating mode. [In standby mode, all functions are invalid by pressing any button (on main unit or remote control) except Stop Button. 2. When people is seated, shortly press Stop Button on main unit to stop front cleaning, rear cleaning or drying functions; When no one is seated, repeatedly press Stop Button on the main unit, the main unit will switch between operating mode and power saving mode.

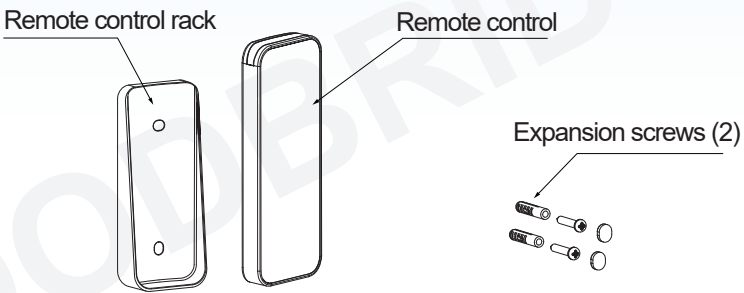
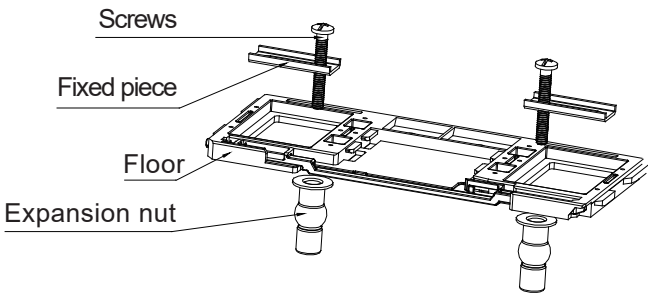
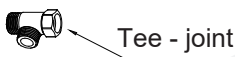
Packing List

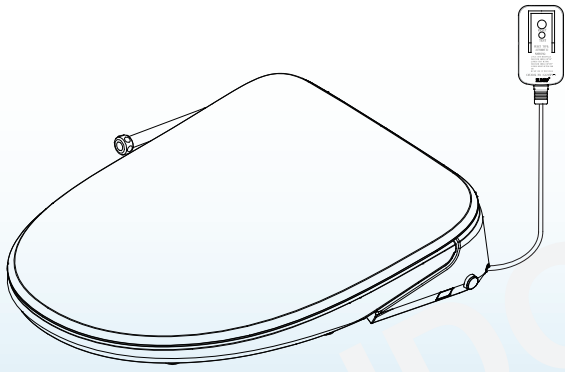
The remote control assembly	1.Remote control	
	2.Remote control rack	
	3.Expansion screws (2)	
Base plate assembly	1.Base plate	
	2.Screws (2)	
	3.Fixed piece (2)	
	4.Expansion nut (2)	
The filter assembly	Tee - joint (1)	
Manual, Certificate of quality, Mounting Cardboard	Manual(including warranty card)	
	Certificate of quality	
	Mounting Cardboard	
Main unit		

Product Size and Installation Preparation Tool

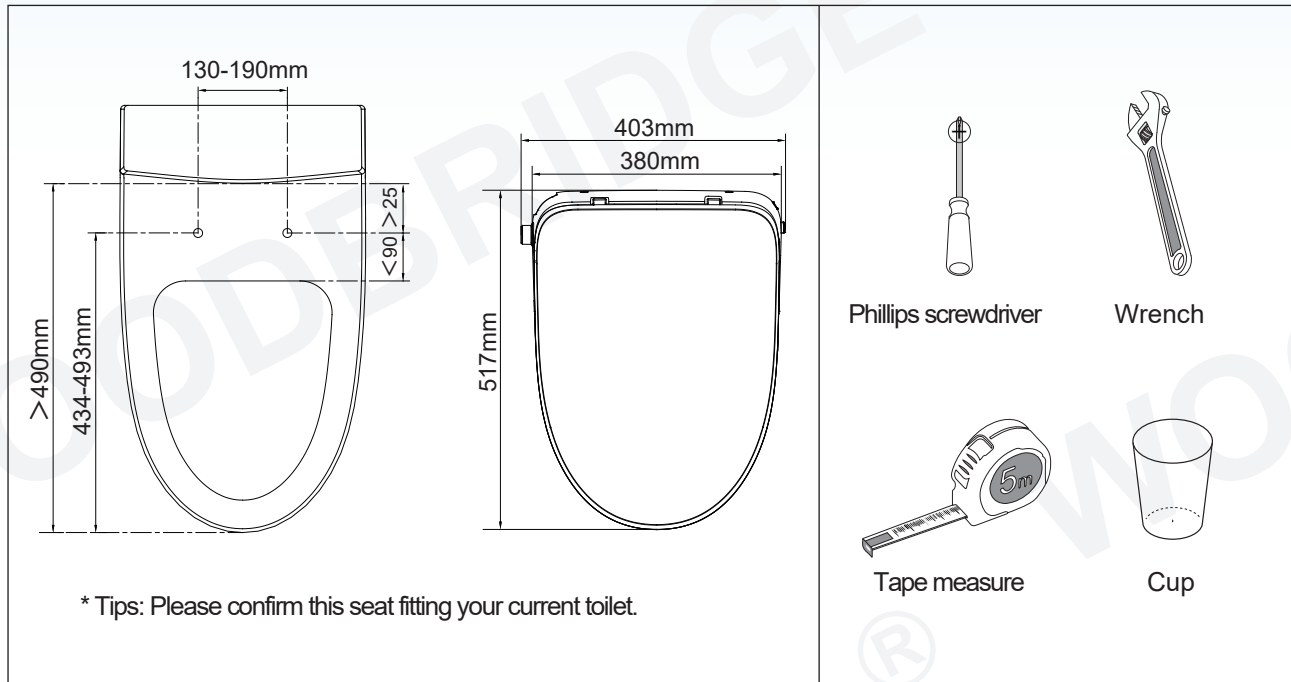

Installation of Main Unit

* This product has been tested for water flow before leaving the factory. There may be a small amount of residual water dripping out when removing the product, which is not a malfunction.

* Do not install this product in a wet place such as a bathroom, and do not put it in a place prone to water.

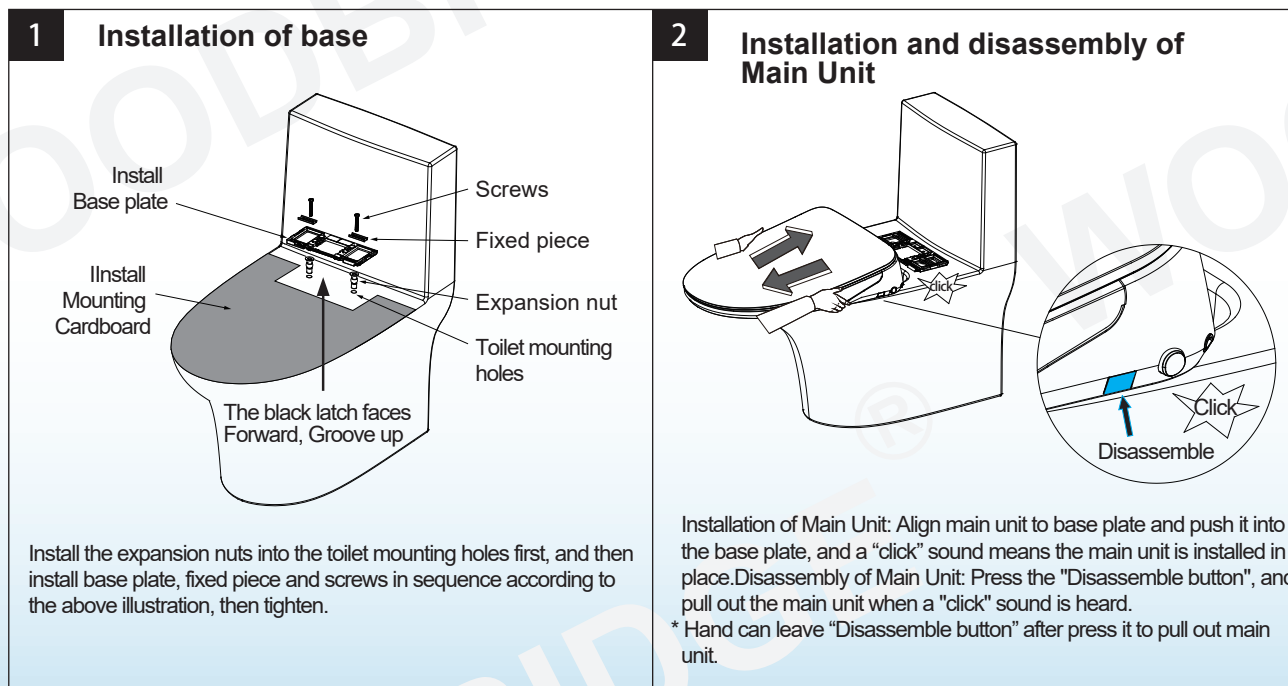

3 Installation of Water inlet pipe and Tee joint

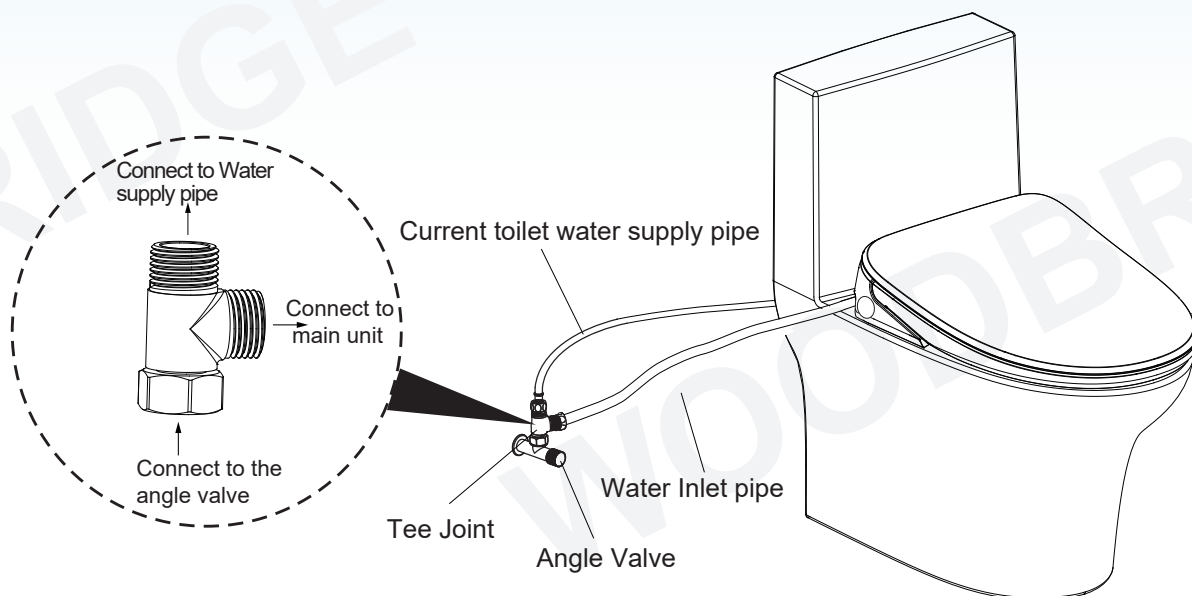

- ① Connect Tee joint to angle valve; (The original Tee joint should be removed);
- ② Connect the inlet end of water supply pipe to Tee joint according to the above illustration;
- ③ Connect main unit to Tee joint according to the above illustration.

Preparation for Start-Up

1. Turn on the angle valve

- Check the tightness of the threaded connection to ensure that there is no water leakage. Turn the angle valve counterclockwise to adjust the opening to the maximum.
(Tips: when the valve is opened for the first time, the angle valve handle has a large torque)

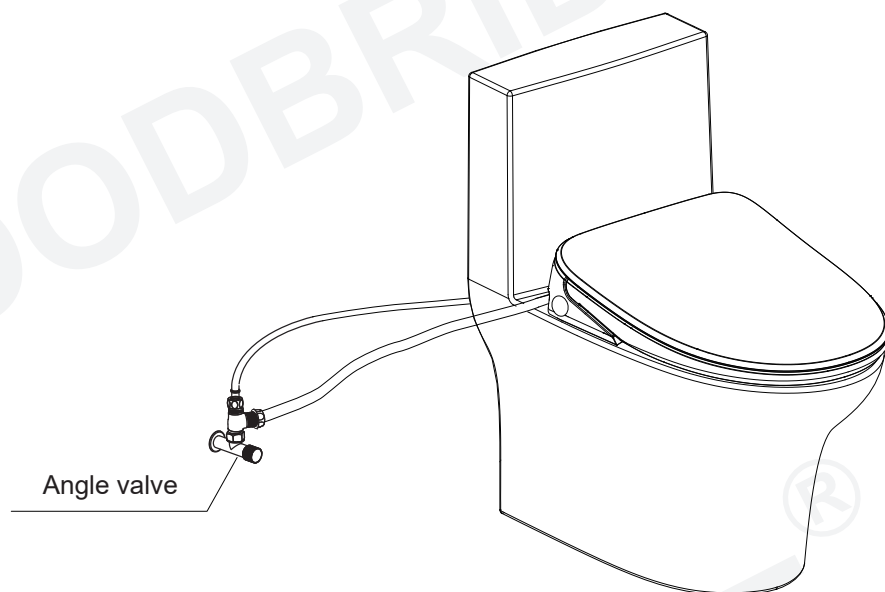

2. Power Connection

- Insert power line leakage protection plug into the power socket, press the reset switch, plug indicator lights on indicating that the power is on.

Tips:

Press electric leakage test button prior to usage, the reset switch pops up indicating that the leakage protection function is normal.

Press the TEST button (then RESET button) every month to assure proper operation.

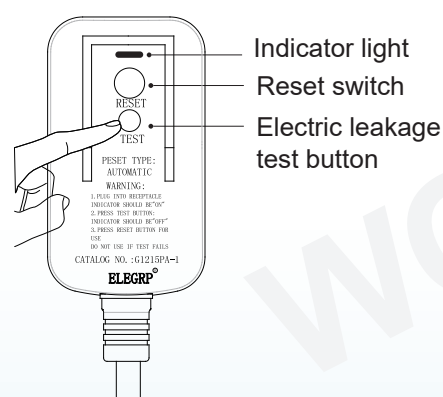

3. Safety self-test

1. The main unit buzzer beeps once, and the knob (button) starts self-test after the white light flashes.
2. The main unit buzzer beeps again, and the self-test is completed, and the knob (button) lights up in white;
3. The function mode is turned on and in normal use.

Daily Maintenance

Maintenance of Main Unit

1. Turn off the power during maintenance of this machine.
2. Wipe the dirty area with a soft cloth that is wrung out of water.
3. After wiping, please turn on the power again.

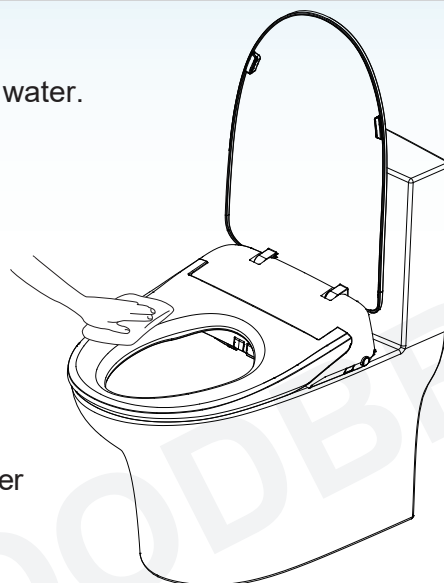
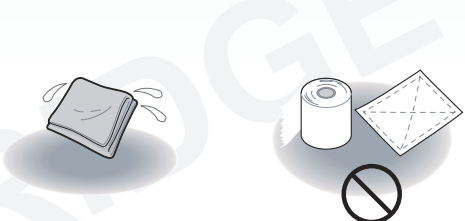

Tips: Do not rinse the surface of the product directly with water during maintenance.

Maintenance of the Nozzle

When there is dirt on the nozzle, maintain it according to the following methods:

1. When no one is seated, turn the knob forward (press Rear Cleaning Button on the main unit), then nozzle rod is extended, and manually clean with a rag or soft brush.
2. Nozzle can be removed and cleaned separately. (Hold the nozzle rod in one hand and pull the nozzle out with the other hand)
3. Put back the nozzle, and then press the knob button (Stop button) on the main unit or the "Stop" button on the remote control, the guided rod retracts.

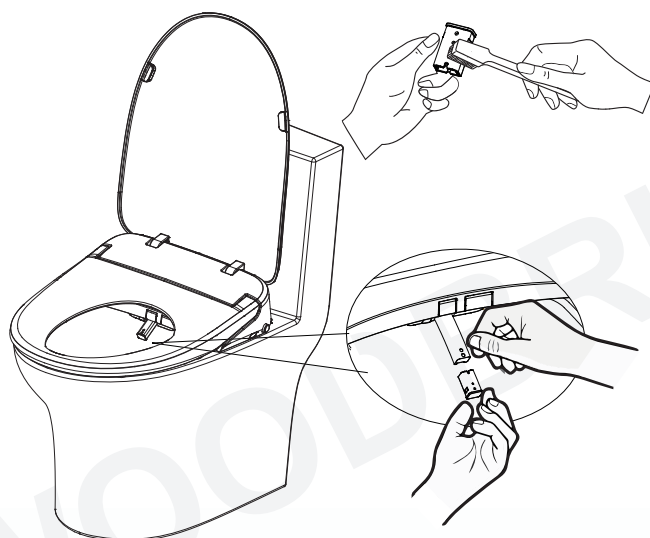
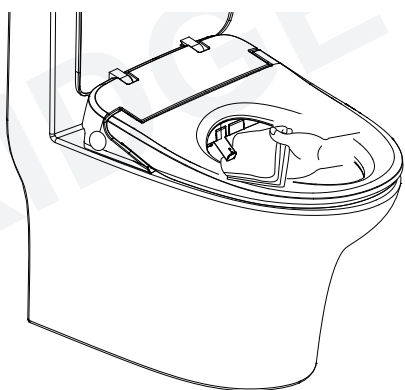

Tips: Do not pull the nozzle rod to prevent the damage of the nozzle rod and motor.

Filter Maintenance

Time for maintenance: It is under normal water pressure but poor flush performance occurs.

1. Turn off the angle valve.
2. Unscrew toilet water inlet pipe and seat water inlet pipe.
3. Take out filter and filter washer
4. Brush filter with toothbrush and clean filter
5. Re-install filter and filter washer, then re-install water inlet pipe

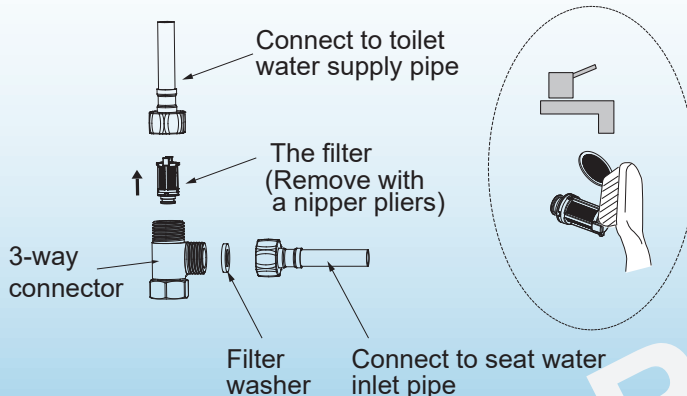

Self-cleaning Waterway Maintenance

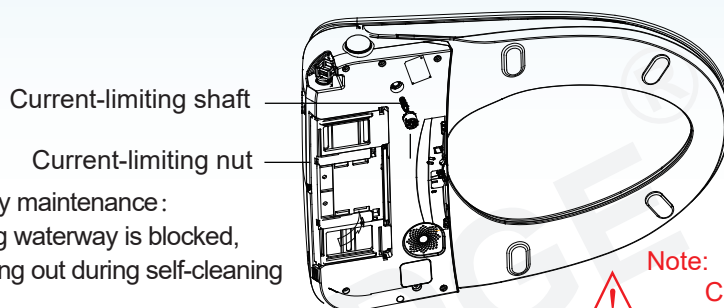

Self-cleaning waterway maintenance:

When the self-cleaning waterway is blocked, there is no water coming out during self-cleaning process.

Note:

Cut off power prior to discharging the water.

1. Turn off the angle valve.
2. Unplug the power plug, cut off the power.
3. Remove the seat, press current-limiting shaft in the middle with a flat-blade screwdriver, then reinstall the seat, and open the inlet valve.
4. If there is still no water coming out after pressing current-limiting shaft, use a flat-blade screwdriver to unscrew current-limiting nut, remove current-limiting shaft, and clean it with a toothbrush or small brush. After cleaning, replace current-limiting nut and current-limiting shaft to the restrictor in the device, then reinstall the seat, and open the inlet valve.

Deodorizing Device Maintenance

Unscrew the screws, take out the deodorant box, and replace the none-photocatalyst.

- ✧ It is recommended to replace the none-photocatalyst after 3 years of use (the specific life span depends on the environment).
- ✧ If you need to replace the none-photocatalyst, please purchase it in the official online store.

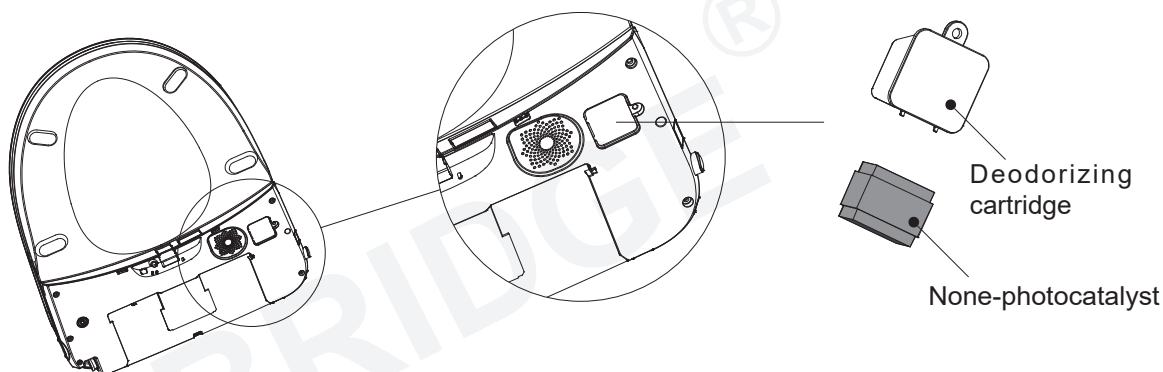

Removal and Installation of Clamp

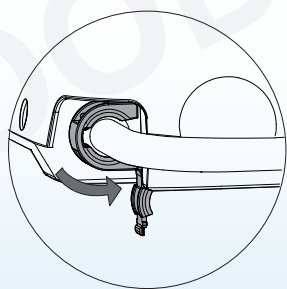

Removal: Open the clamp cover, rotate it counterclockwise, and use a flat-blade screwdriver to pry the clamp out of the slot.

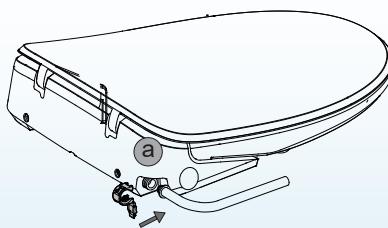

Installation: Install the quick-released connector of water inlet pipe into the main unit, and clip the clamp into the slot.

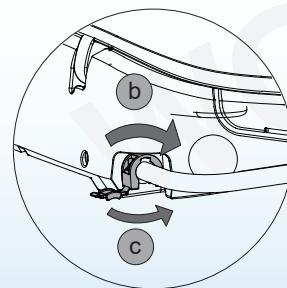

Troubleshooting Guide

Problem	Cause	Solution
No Water from Nozzle	Water inlet hose bent to cause blocking	Solve the problem of bending of water inlet hose
	Inlet valve is off	Turn on the inlet valve
	Water supply is cut off	Connect water supply and wait for the water
Weak water cleaning	Water inlet hose bent to cause partial blocking	Solve the problem of bending of water inlet hose
	Water inlet valve is not fully open	Turn on the inlet valve fully
	Inlet filter blocked	Clean the filter
Low water temperature	The water temperature is set in normal temperature level	Reset the water temperature
low seat temperature	The seat temperature is set in normal temperature level	Reset the seat temperature
	In standby mode	Switch to operating mode and use it after 3 minutes
low wind temperature	The wind temperature is set in normal temperature level	Reset the wind temperature
No wind out	In standby mode or power saving mode	Shift to operating mode to use dry function
Nozzle rod cannot retract	Power off	Push back the nozzle rod lightly and put power on
	Get stuck by impurities	Clear away the impurities
Nozzle rod cannot stretch out	Power off	Put power on
	No sitting in sensing area	Sit right in the sensing area
Remote control cannot display	The battery of the remote control is installed in the opposite direction	Reload the battery
Malfunction of deodorization	User doesn't reach the sensing area in seat	Adjust to reach the sensing area
	Deodorization function keeps working after user leaves	It's a normal phenomenon if deodorization function keeps working after user leaves to ensure eliminating smell entirely
 Caution	If the problems cannot be solved as per above methods, please turn off the power , and contact service providers for maintenance.	
	If the power leakage protection switch always trips, it means that the product is leaking. Please turn off the power, contact the service provider, and ask for professional repairs.	

NOTES

DATE OF INSTALL:

INSTALLER'S NAME:

PLUMBER:

☐

CONTRACTOR:

☐

LICENSE #:

Customer Service Phone: 562-229-0088. (Monday - Friday 9 AM - 5 PM Pacific Time)

Or Email: help@woodbridgebath.com

USER MANUAL BID 02

WOODBIDGE®

Remote Control Illustration

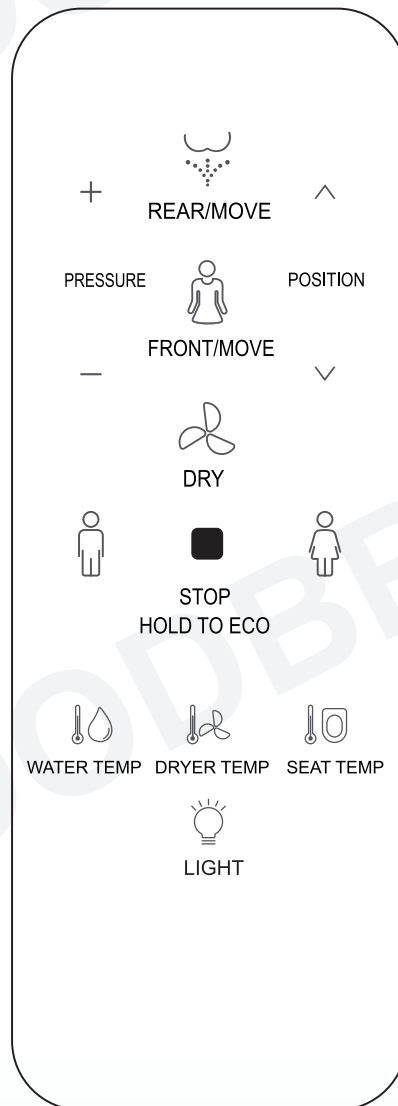

Thank you for choosing our product. Please read the instructions carefully before installation and keep it available for future maintenance or reference.

Customer Service Phone: 562-229-0088. (Monday - Friday 9 AM - 5 PM Pacific Time)
Or Email: help@woodbridgebath.com

2020413 REV. 2

Installation Preparation

Remote control installation

Remote control hanger installation

- (1) Place the remote control hanger upright on the pre-installed area of the wall and mark the location of the two mounting holes on the wall with a marker. Drill a hole in the marked position on the wall with a drill bit of 6 mm in diameter, with a depth of 35 mm. (When determining the installation location, note that when the person sits on the seat to ensure that the user can catch the remote control.)
- (2) Put the expansion tube into the wall hole and the hanger is tight against the wall. Align the hole in the hanger with the expansion tube and tighten the screw, and then cover the silicone gasket.

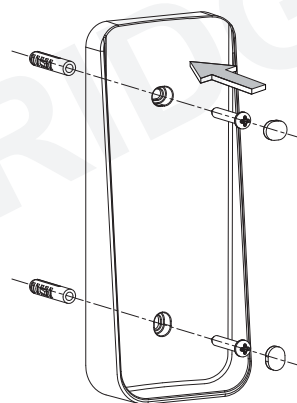
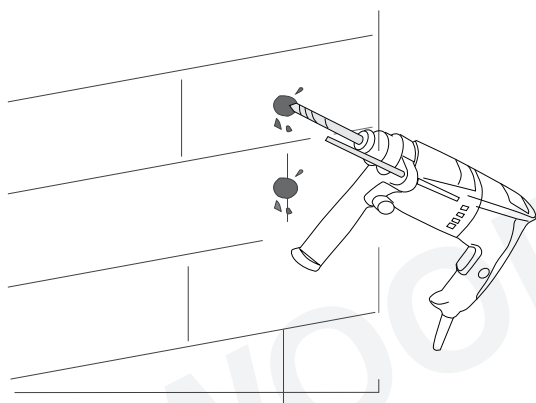

- (3) Put batteries into remote control and cover remote control.

- (4) Put remote control to the hanger.

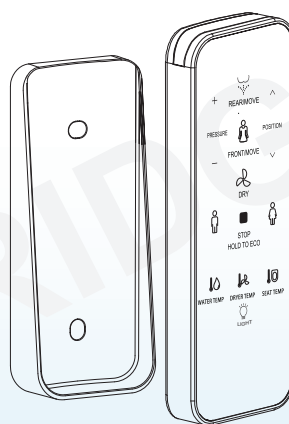
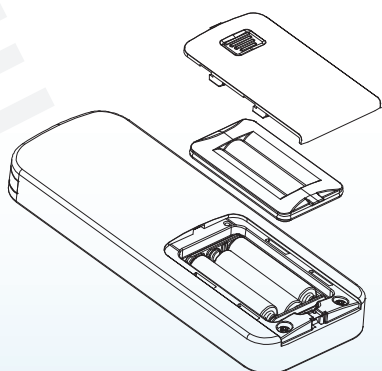

Notice : Don't install and use the product in damp places such as shower room.
Don't place the product in a place where it is easily exposed to water.

Installation Preparation

Remote control installation

Remote control hanger installation (Only for the hanger matching with fixing board and foam gasket.)

- (1) Clean and dry the pre-installed area of the remote control rack on the wall. (When determining the installation location, make sure that the user can reach remote control when he sits on the seat.)
- (2) Remove the adhesive tape on the back of the hanger and place it tightly against the wall, then cover the silicon gasket.

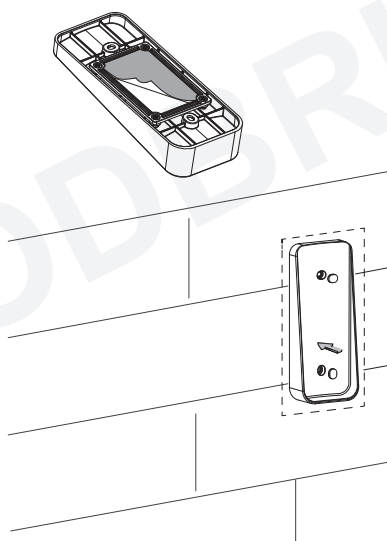
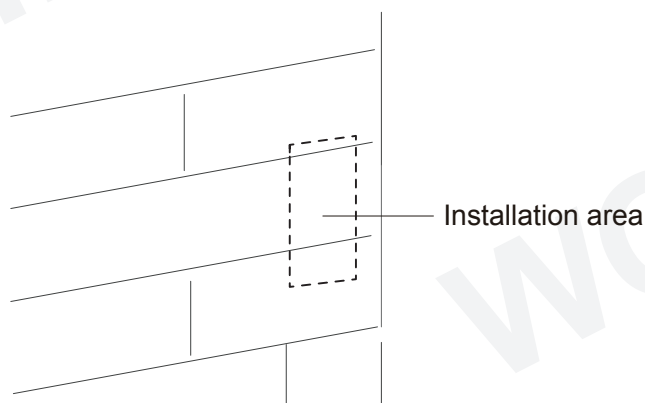

- (3) Put batteries into remote control and cover remote control.

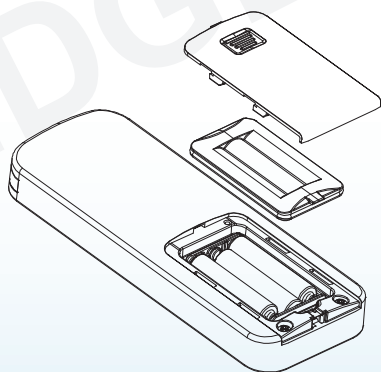

- (4) Put remote control to the hanger.

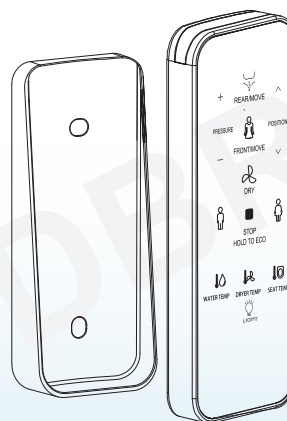

Notice : Don't install and use the product in damp places such as shower room.
Don't place the product in a place where it is easily exposed to water.

Usage Instruction

Remote control illustration

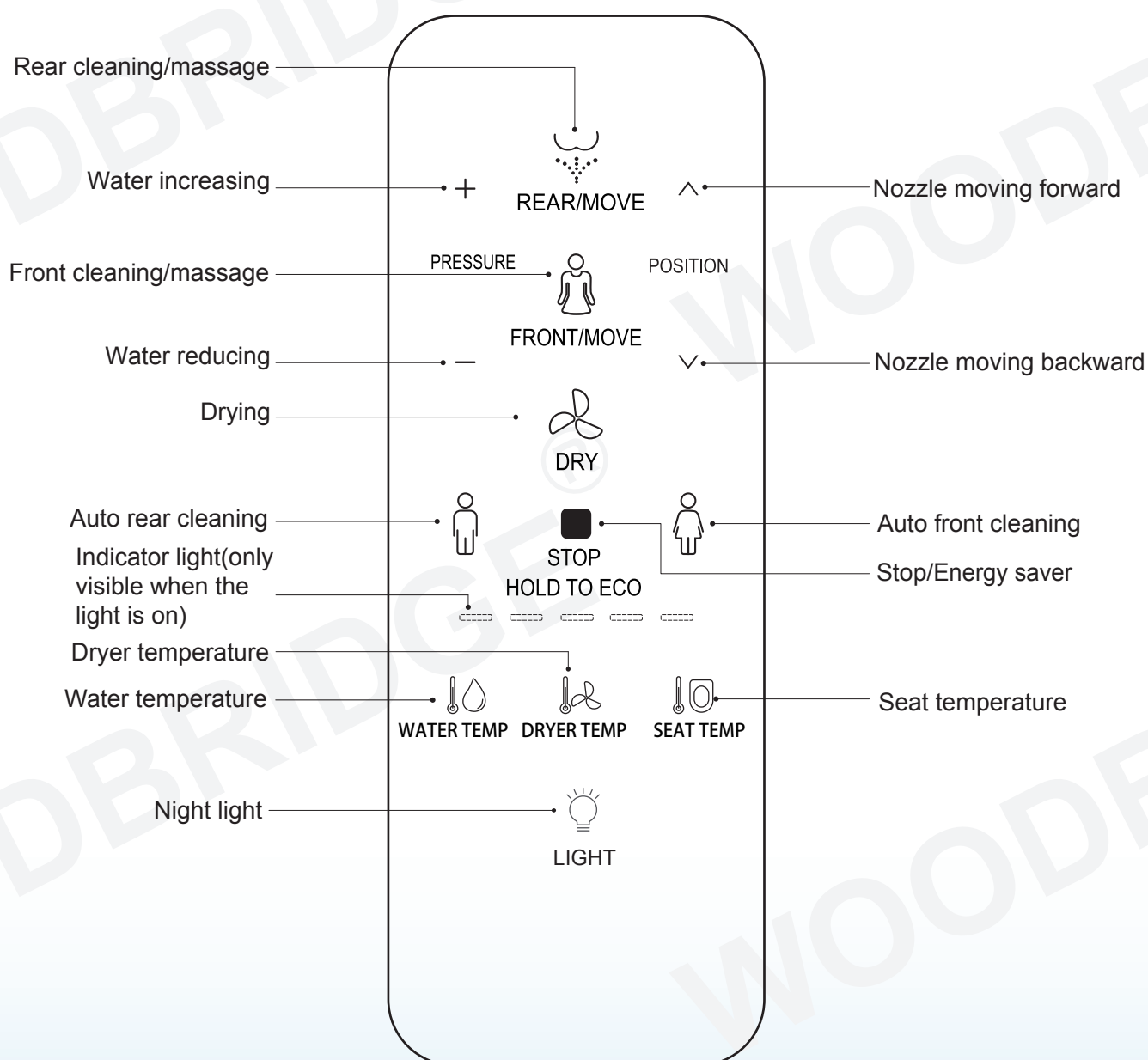

Usage Instruction

Rear/Front cleaning

- Press “Rear cleaning/massage” button, the indicator light is on showing current water temperature level, it starts rear cleaning; Press again “Rear cleaning/massage” button to shift to massage to massage cleaning (nozzle moves forward and backward to expand cleaning area). The cleaning will last for a circle and stop automatically, while it will stop immediately if the user presses “STOP” button.
- Press “Front cleaning/massage” button, the indicator light is on showing current water temperature level, it starts front cleaning; Press again “Front cleaning/massage” button to shift to massage cleaning (nozzle moves forward and backward to expand cleaning area). The cleaning will last for a circle and stop automatically, while it will stop immediately if the user presses “STOP” button.

Drying Operation

- Press “Dry” button, the indicator light is on showing current wind temperature level, it starts drying; it will stop drying automatically after a circle or the user leaves the seat.

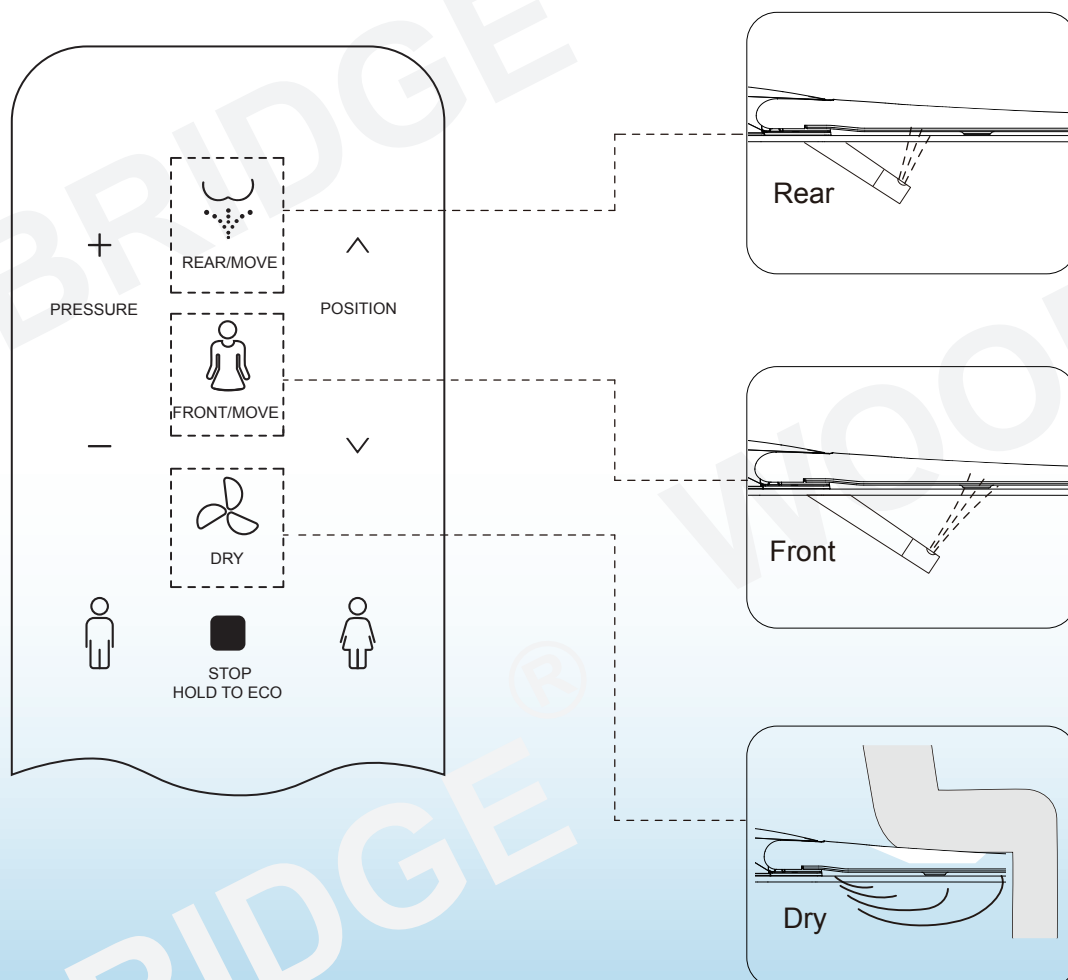

Usage Instruction

Water volume adjustment

- Presss “+” or “-” button when it is under function of rear cleaing or front cleaning, the indicator light will be on showing current water volume level, adjust water volume by levels.

Spray nozzle position adjustment

- Presss “^” or “v” button when it is under function of rear cleaing or front cleaning, the indicator light will be on showing current nozzle position, adjust nozzle position by 5 levels.

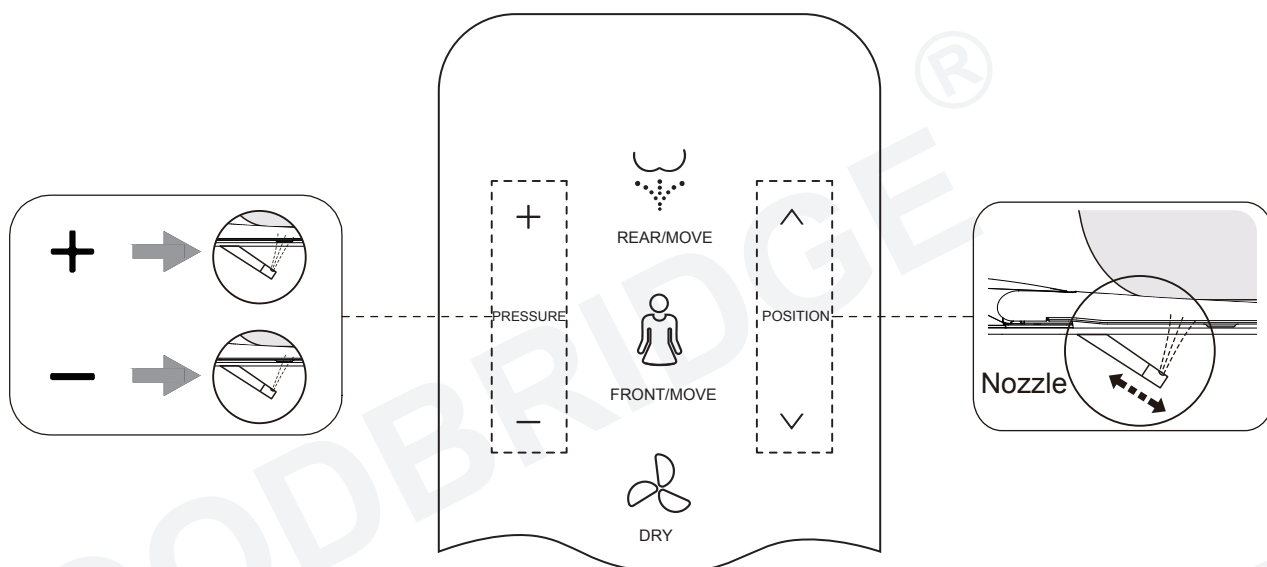

Usage Instruction

Energy saver

Keep pressing "STOP" button for more than 3S to enter energy saving mode, the indicator light will be off and energy saving light will be on. Keep pressing "STOP" button again for more than 3S to exit energy saving mode, the indicator light will be on and energy saving light will be off.

Energy saving

Under energy saving mode, seat temperature is low(level 1) to achieve energy saving. (Note: If the seat temperature before energy saving is neutral, keep the neutral after energy saving)

Remark

Energy saving mode will be suspended and goes to function mode if someone uses the seat in the middle of energy saving. The seat starts to heat immediately (without closing the seat temperature), and the energy saving mode is restored after the human body leaves the seat.

Auto function

- The automatic function of factory default setting is middle level for water volume, nozzle position, water temperature, air temperature, seat temperature.
- Short press on the remote control button "♂", "♀" can achieve male hip wash and female bidet wash, fully automatic and convenient use. The user can firstly set the water volume, nozzle position, water temperature gear position and air temperature gear position. After the setting is completed, press the corresponding automatic key 3s to save the setting. The next time you use it, you can call the saved key by pressing the corresponding automatic key. Set the automatic function to enable automatic cleaning and drying in the whole process.
- The Auto function mode will be off if the user presses other buttons during operation of auto functions and shift to operate the functions of the buttons.

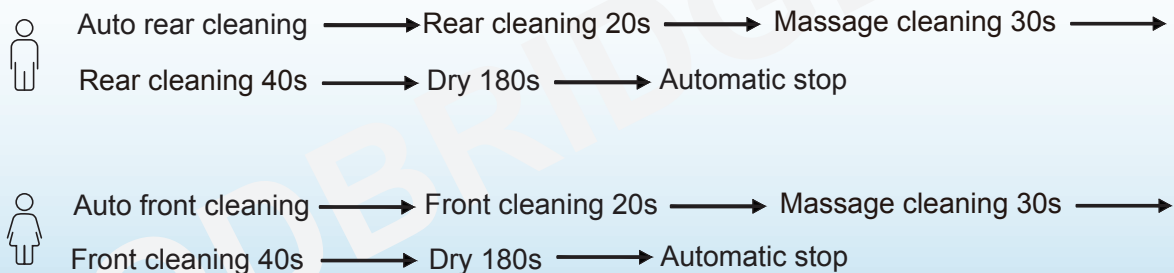

Tips: Certain models don't have drying function.

Usage Instruction

Temperature adjustment

· Water temperature adjustment

Short press the “WATER TEMP” button to adjust the water temperature. The indicator will show the water temperature level if it's on. When the indicator is off, the water level is 0. Short press this button to adjust water temperature level from 0 to 5 in cycle. (Note: the water temperature is set at $10 \pm 2.5^{\circ}\text{C}$ in level 0, that is, when the inlet water temperature is higher than 10°C , the water won't be heated, while when the inlet water temperature is lower than 10°C , the water will be heated to about 10°C .)

· Dryer temperature adjustment

Short press the “DRYER TEMP” button to adjust the dryer temperature. The indicator will show the dryer temperature level if it's on. When the indicator is off, the wind level is 0. Short press this button to adjust dryer temperature level from 0 to 5 in cycle.

· Seat temperature adjustment

Short press the “SEAT TEMP” button to adjust the seat temperature. The indicator will show the seat temperature level if it's on. When the indicator is off, the seat level is 0. Short press this button to adjust seat temperature level from 0 to 5 in cycle.

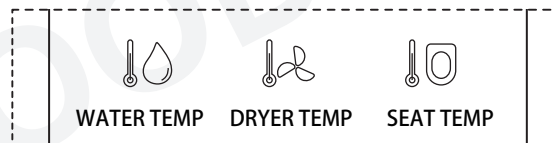

Night light (Only for toilets with night light function)

· Short press “Night light” button to turn on/turn off night light, long press “Night light” button to enter into intelligent mode (Night light will be on or off by detecting the lightness of surroundings). If the product is on intelligent mode, short press “Night light” button to exit intelligent mode.

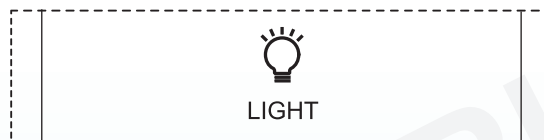

Usage Instruction

Other Operations

User Code

- The user code needs to be set to avoid disturbance from remote controls when more than one smart toilets are used in the house. Turn on the toilet for setting while turning off others. Press user code combination buttons (Press "STOP" button first and then press "REAR" button) to enter user code setting mode, the indicator lights will be on and keep flashing.
- (RF remote control) The Remote control will generate matching user code automatically, press user code combination buttons again to exit setting mode and setting is completed. When the main unit is powered off to restart or change remote control batteries, user code won't be cleared and no need to reset.
- (IR remote control) Press water volume "+" "-" buttons to select user code. The indicator shows the corresponding user code. Press the user code combination buttons again to save settings and exit. The buzzer beeps and it's set successfully. When the main unit is powered off to restart or batteries are removed from remote control, the user code will be cleared and need to be reset. After entering setting mode, if there's no operation for 10s, the remote control will exit setting mode automatically and return to previous states.

Quit mode

Long press "SEAT TEMP" button to turn on/off quit mode.

Auto deodorization

Press "Stop" button first and meanwhile press "FRONT" button to start or close auto deodorizing function; While the auto deodorization function is on, when it's detected that the user is seated, it'll start deodorizing and stops when user leaves above 3s. The auto deodorization function will turn off automatically during drying. (This function only applies to product with auto deodorization function. This function is set to on by default.)

Remark:

- The buzzer will sound "BEEP" when the user presses one button which means the main unit receives the signal and conduct the operation accordingly. If the buzzer doesn't sound, it means the main unit doesn't receive the signal, please adjust the remote control direction and repress the button.
- In case of power cut during wand's spray operation, the wand cannot go back to place, please wait until the power is reset. In case of a power cut for a long period, please push the wand softly back by hand. Do not push hard, to avoid damage to wand and electrical machine.
- The body should touch the seat and the buzzer rings "CLICK", which means functions of front cleaning, rear cleaning and drying are in operation. The nozzle will continue to spray for 1-2 seconds after user stands up during spray operation, so please press "STOP" button before standing up.

Customer Service Phone: 562-229-0088. (Monday - Friday 9 AM - 5 PM Pacific Time)

Or Email: help@woodbridgebath.com